

REFERENCES WHEELS

356492 C Carb Ultimate 14 Rr

356493 C Carb Ultimate 14 Rr

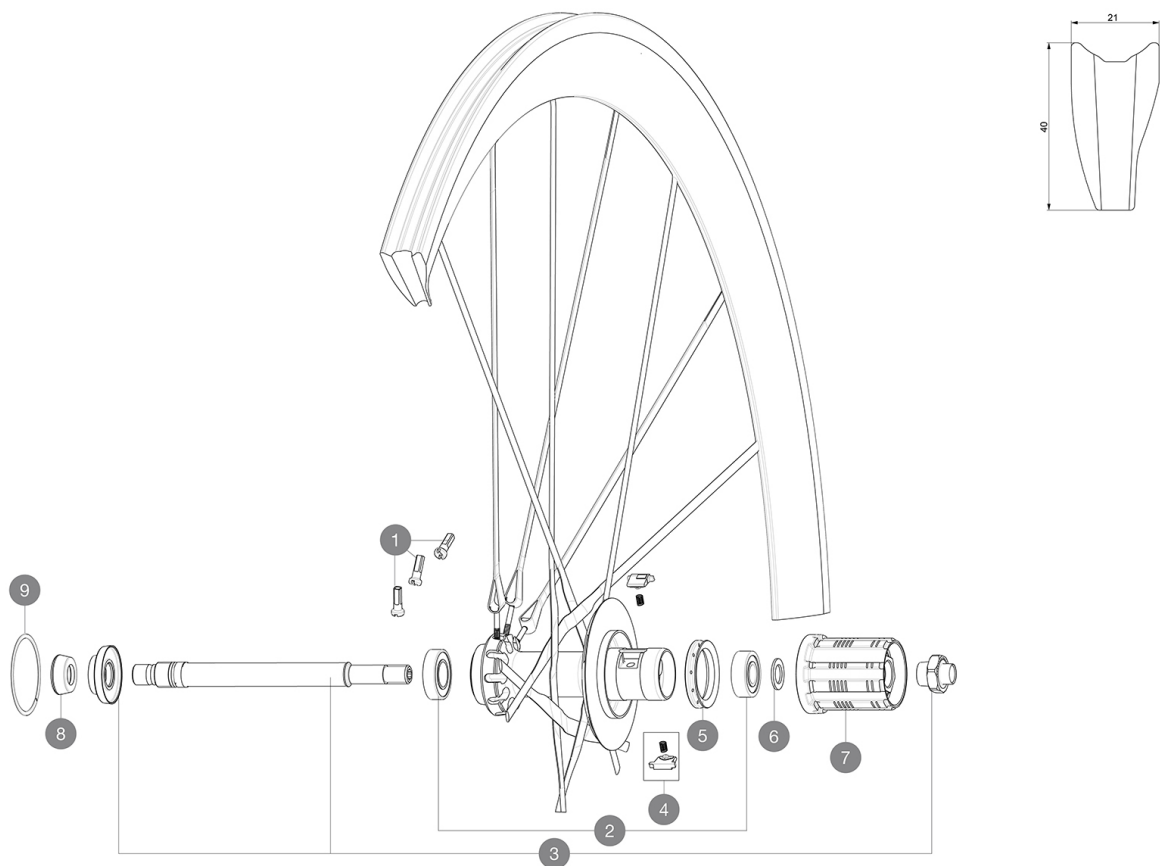

SPOKES

1	L99603600	KIT 10 NIPPLES COSMIC CARBON ULTIMATE
----------	-----------	---------------------------------------

HUB SHELLS

1	LM4007700	REAR HUB 608+6901 BEARINGS
2	L33000000	REAR HUB B9+6901 BEARINGS 2013
3	LV2250800	KIT REAR AXLE COSMIC ULTIMATE
4	LM4057800	FTSL PAWLS KIT (ROAD WHEELS)
5	L99500000	FTSL/FTSX FREEHUB BODY SEAL
6	L30872800	SET OF 3 INTERNAL SILVER SPACERS 9mm FTS-L
7	L30871100	FTS-L ROAD FREEWHEEL BODY HG11 8/9 compatible
7	L30871200	FTS-L ROAD FREEWHEEL BODY ED11 8/9 compatible
8	L35117300	FT/RR FORK REST R-SYS/CC ULTIMATE > 2013/KSY PRO CARB T
9	L99604500	SET OF 2 R.HUB RING COS.CARB.ULTIMATE

MAVIC Cosmic Carbone Ultimate

DELIVERED WITH

BR601 Titanium quick releases	
Wheelbags	
Carbon brake pads	
Valve extender	
Computer magnet (front wheel)	
Multifunction adjustment wrench	
User guide	

Specifications

RIMS

- **Material** : 100% woven 12K carbon fiber
- **Height** : 40 mm
- **Drilling** : no holes, spokes molded to the rim
- **Brake track** : carbon with TgMAX technology
- **Brake track** : carbon
- **Valve hole diameter** : 6.5 mm
- **Tyre** : tubular
- **ETRTO size** : 28" tubular
- **Recommended tyre sizes** : 19 to 28 mm

SPOKES

- **Material** : unidirectional carbon fiber
- **Shape** : R2R
- **Nipples** : brass, ABS
- **Count** : 20 front and rear
- **Lacing** : crossed 2 front and rear drive side, radial non drive side

WHEEL HUB

- **Front body** : Front 100% carbon
 - **Rear body** : aluminum
 - **Axle material** : aluminum
- Adjustable sealed cartridge bearings
- **Freewheel** : FTS-L steel

WHEEL WEIGHTS

Wheel weight 665