

REFERENCES WHEELS

359915 Cosmic Carbone 40 C Rr

359916 Cosmic Carbone 40 C Rr

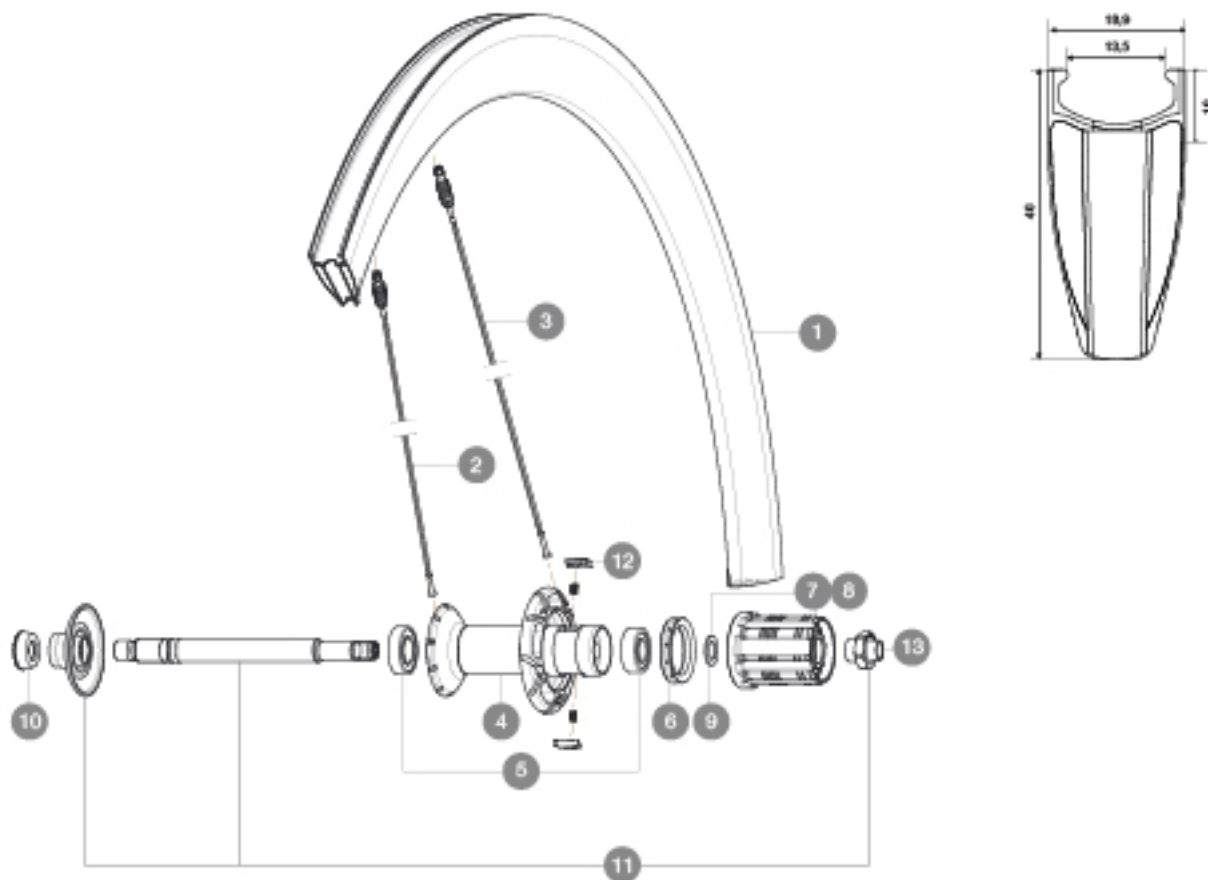

RIMS



&NBSP;:

1 L32978200 KIT REAR RIM CC 40 CLINCHER

SPOKES

2 L3297900001 KIT 10 AERO FT/NDS CC 40 C BLACK SPOKE 277mm - while stock I
 2 LV3664200 KIT 12 FRT/NDS STAINLESS SPOKE CC40 C 277mm
 3 LV3664100 KIT 12 DRIVE SIDE STAINLESS SPOKE CC40 C 275mm
 3 L3297890001 KIT 10 AERO DS CC 40 C BLACK SPOKE 275mm - while stock last

HUB SHELLS

4 N/A HUB BODY
 5 L33000000 REAR HUB B9+6901 BEARINGS 2013
 6 L99500000 FTSL/FTSX FREEHUB BODY SEAL
 7 L30871100 FTS-L ROAD FREEWHEEL BODY HG11 8/9 compatible
 8 L30871200 FTS-L ROAD FREEWHEEL BODY ED11 8/9 compatible
 9 L30872800 SET OF 3 INTERNAL SILVER SPACERS 9mm FTS-L
 10 L35117300 FT/RR FORK REST R-SYS/CC ULTIMATE > 2013/KSY PRO CARB T
 11 LV2250300 KIT REAR AXLE AERO HUB CXR/CC40/CC SLS/CC SLE/COSMIC PRO CAR
 12 LM4057800 FTSL PAWLS KIT (ROAD WHEELS)
 13 LV2373100 KIT NUT FOR ROAD ALLOY THROUGH AXLE 9mm

MAVIC *Cosmic Carbone 40 C***DELIVERED WITH**

BR601 quick releases

Specifications**RIMS**

- **Material** : 3K carbon fibers with aluminum reinforced rim bed
- **Height** : 40 mm
- **Drilling** : co-molded Fore drilled inserts
- **Brake track** : carbon with TgMAX technology
- **Valve hole diameter** : 6.5 mm
- **Tyre** : clincher
- **ETRTO size** : 622x13C
- **Recommended tyre sizes** : 19 to 28 mm

SPOKES

- **Material** : steel
- **Shape** : straight pull, bladed, double butted
- **Nipples** : Fore integrated aluminum
- **Count** : 20 front and rear
- **Lacing** : radial front and rear non-drive side, crossed 2 rear drive side

WHEEL HUB

- **Front and rear bodies** : carbon center tube and aluminum flanges
- **Axle material** : aluminum
- Sealed cartridge bearings
- **Freewheel** : FTS-L steel

WHEEL WEIGHTS

Wheel weight 875