

## REFERENCES WHEELS

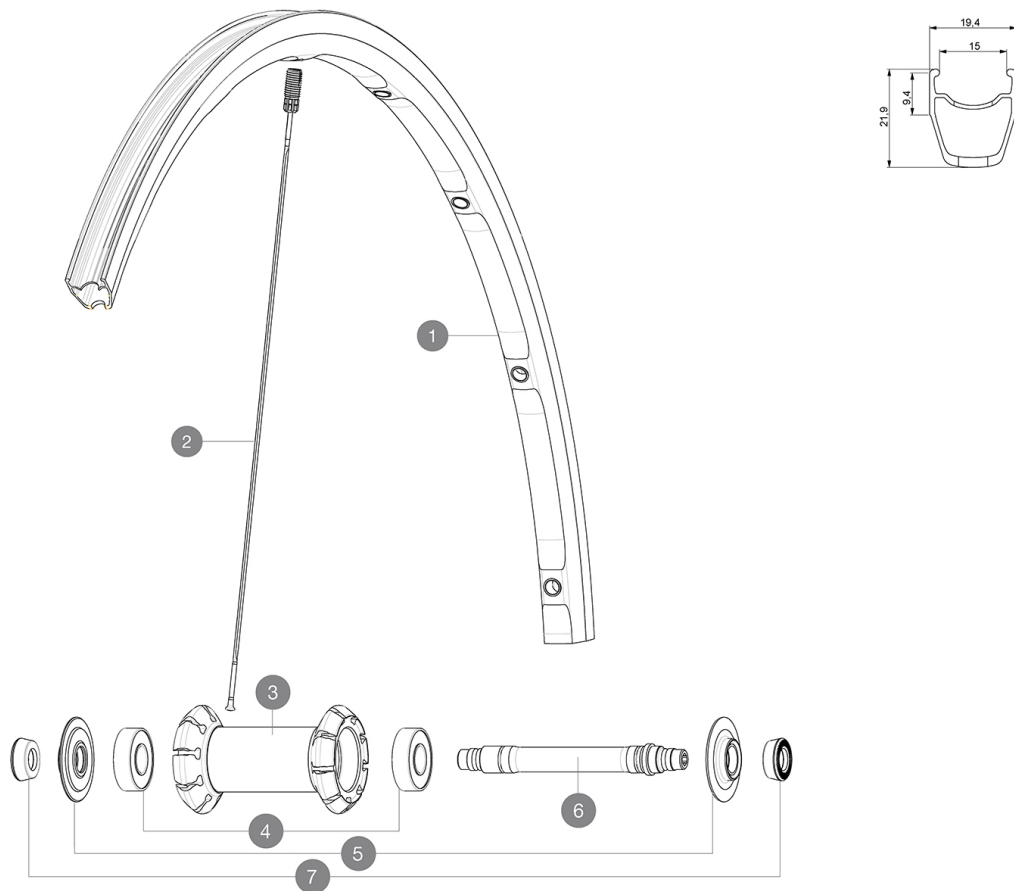

### RIMS



&NBSP;:

1	LV2400400	KIT FRONT KSYRIUM ELITE RED S BLACK RIM
1	L33002300	KIT FRONT KSYRIUM ELITE S BLACK/SILVER RIM

### SPOKES

2	LV2270700	KIT 9 FRONT KSYRIUM ELITE S RED SPOKE 284mm
2	L33002700	KIT 9 FT KSYRIUM ELITE S BLK SPK 285,5mm

### HUB SHELLS

3	N/A	HUB BODY
3	N/A	HUB BODY
4	LM4031800	KIT 2 HUB BEARINGS 6001
5	L12038200	KSYRIUM ELITE HUB CAP AND ADJUSTING NUT
6	L99686100	KSYRIUM ELITE 09 FRONT AXLE
7	LM4006300	2 FRONT AXLE FORK SUPPORT

**MAVIC** *Ksyrium Elite S***DELIVERED WITH**

BR301 quick releases	
Multifonction adjustment wrench	
User guide	

**Specifications****RIMS**

- **Material** : Maxtal
- **Height** : front 22 mm, rear 25 mm asymmetrical
- **Joint** : SUP
- **Drilling** : Fore
- **Brake track** : UB Control
- **Weight reduction** : ISM
- **Valve hole diameter** : 6.5 mm
- **Tyre** : clincher
- **ETRTO size** : 622x15C
- **Recommended tyre sizes** : 19 to 32 mm

**SPOKES**

- **Material** : steel
- **Shape** : straight pull, bladed, front double butted
- **Nipples** : Fore integrated aluminum
- **Count** : front 18, rear 20
- **Lacing** : front radial, rear Isopulse

**WHEEL HUB**

- **Front and rear bodies** : aluminum
  - **Axle material** : aluminum
- Adjustable sealed cartridge bearings
- **Freewheel** : FTS-L steel

**WHEEL WEIGHTS**

Wheel weight 680