

## REFERENCES WHEELS

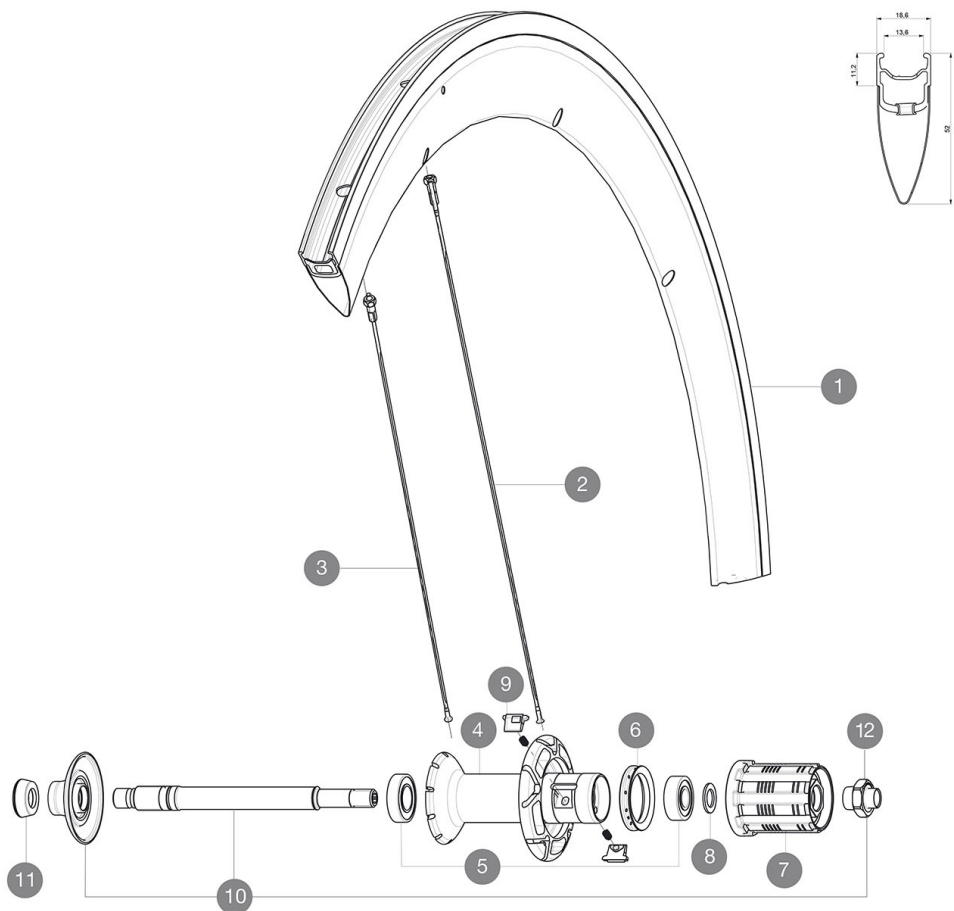

### RIMS



&NBSP;:

- 1 LV4091600 KIT REAR RIM COSMIC CARBON SLS/COSMIC PRO CARBON V shaped
- 1 L12017100 KIT REAR COSMIC CARBONE SL 11 RIM - while stock last

### SPOKES

- 2 L36644400 KIT 10 DS COSMIC CARBON SLS BLK SPK 287mm
- 3 L36644500 KIT 10 FT/NDS COSMIC CARBON SLS BLK SPK 289mm

### HUB SHELLS

- 4 N/A HUB BODY
- 5 L33000000 REAR HUB B9+6901 BEARINGS 2013
- 6 L99500000 FTSL/FTSX FREEHUB BODY SEAL
- 7 L30872800 SET OF 3 INTERNAL SILVER SPACERS 9mm FTS-L
- 8 L30871200 FTS-L ROAD FREEWHEEL BODY ED11 8/9 compatible
- 8 L30871100 FTS-L ROAD FREEWHEEL BODY HG11 8/9 compatible
- 9 LM4057800 FTSL PAWLS KIT (ROAD WHEELS)
- 10 LV2250300 KIT REAR AXLE AERO HUB CXR/CC40/CC SLS/CC SLE/COSMIC PRO CAR
- 11 L35117300 FT/RR FORK REST R-SYS/CC ULTIMATE > 2013/KSY PRO CARB T
- 12 LV2373100 KIT NUT FOR ROAD ALLOY THROUGH AXLE 9mm

**MAVIC** *Cosmic Carbone SLS***DELIVERED WITH**

BR601 quick releases	
Multifonction adjustment wrench	
User guide	

**Specifications****RIMS**

- **Material** : Maxtal and 12K carbon fiber
- **Height** : 52 mm
- **Joint** : SUP
- **Drilling** : traditional
- **Brake track** : UB Control
- **Weight reduction** : ISM
- **Valve hole diameter** : 6.5 mm
- **Tyre** : clincher
- **ETRTO size** : 622x13C
- **Recommended tyre sizes** : 19 to 28 mm

**SPOKES**

- **Material** : steel
- **Shape** : straight pull, bladed
- **Nipples** : brass, ABS
- **Count** : front 16, rear 20
- **Lacing** : radial front and rear non-drive side,  
crossed 2 rear drive side

**WHEEL HUB**

- **Front and rear bodies** : aluminum
  - **Axle material** : aluminum
- Adjustable sealed cartridge bearings
- **Freewheel** : FTS-L steel

**WHEEL WEIGHTS**

930