

REFERENCES WHEELS

R42101 Ksyrium SLR 15 Rr

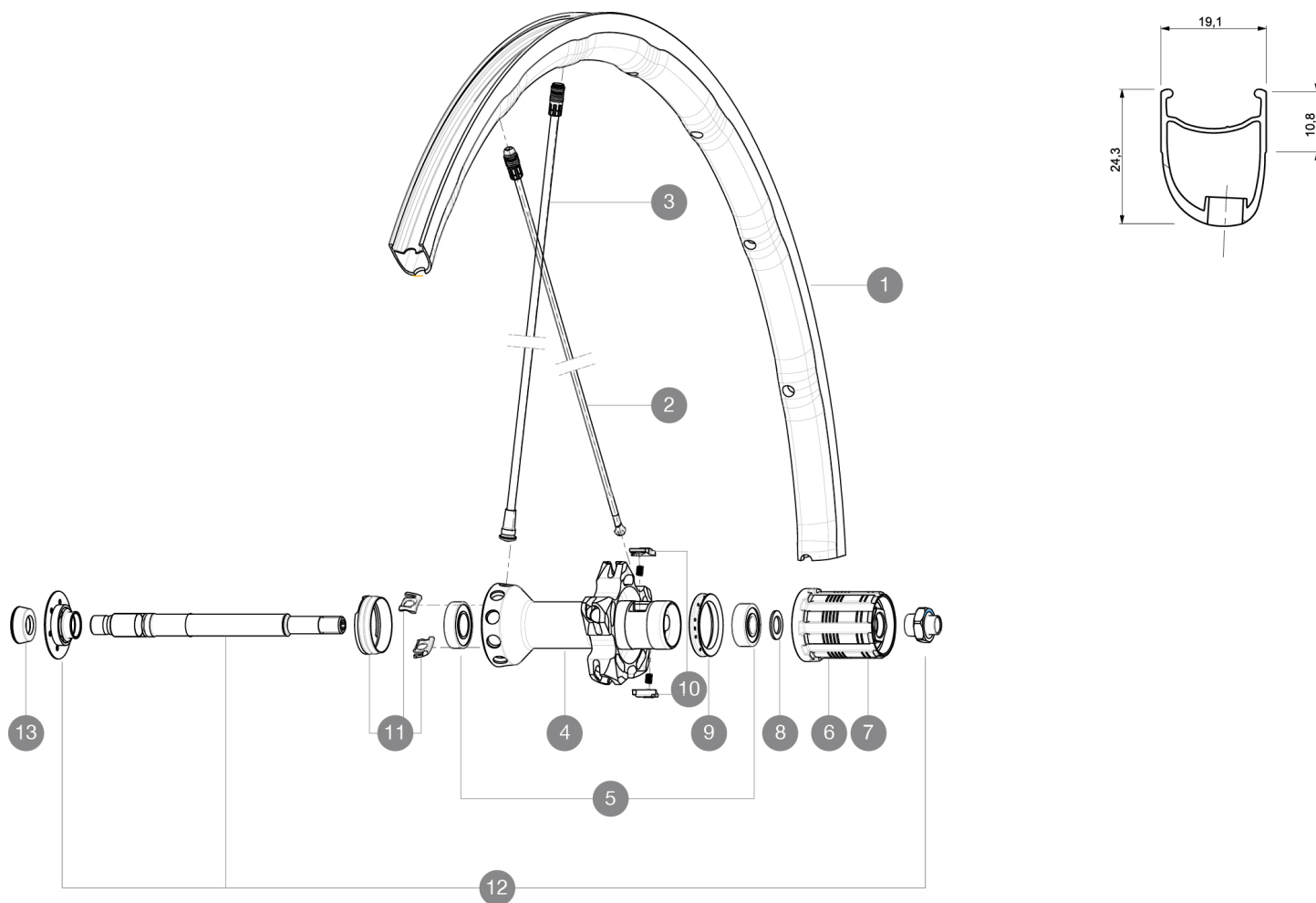

RIMS



VALVE HOLE Ø (MM): 6.5 :

1	LV2290200	KIT REAR RIM KSYRIUM PRO SL EXALITH (SLR 15)
---	-----------	--

SPOKES

2	LV2270400	KIT 10 DS R-SYS SLR/KSY SLR ALU SPK 293,5mm
3	LV4161300	Kit 10 front/rear Rsys spokes 282,7mm from 2020
3	LV2270300	KIT 10 NDS R-SYS/KSY SLR CARB SPK 282,7mm -while stock last
11	L99693800	2 SILVER TRACOMP RINGS + CLIPS

HUB SHELLS

4	N/A	HUB BODY
5	L33000000	REAR HUB B9+6901 BEARINGS 2013
6	L30871100	FTS-L ROAD FREEWHEEL BODY HG11 8/9 compatible
7	L30871200	FTS-L ROAD FREEWHEEL BODY ED11 8/9 compatible
8	L30872800	SET OF 3 INTERNAL SILVER SPACERS 9mm FTS-L
9	L99500000	FTSL/FTSX FREEHUB BODY SEAL
10	LM4057800	FTSL PAWLS KIT (ROAD WHEELS)
12	LV2250200	KIT REAR AXLE KSYRIUM SLR/K125/R-SYS/ELITE 16
13	L35117300	FT/RR FORK REST R-SYS/CC ULTIMATE > 2013/KSY PRO CARB T

MAVIC *Ksyrium SLR***DELIVERED WITH**

BR601 quick releases	
Wheelbags	
Exalith brake pads	
Computer magnet (front wheel)	
Multifonction adjustment wrench	
User guide	

Specifications**RIMS**

- **Material** : Maxtal
- **Height** : front 24mm, rear 26 asymmetrical
- **Joint** : SUP
- **Drilling** : Fore
- **Brake track** : Exalith 2
- **Weight reduction** : ISM4D
- **Valve hole diameter** : 6.5 mm
- **Tyre** : clincher
- **ETRTO size** : 622x15C
- **Recommended tyre sizes** : 19 to 32 mm

SPOKES

- **Material** : front and rear drive side Zicral, Rear non drive side carbon fiber
- **Shape** : front and rear drive side straight pull bladed double butted, rear non drive side Tracomp
- **Nipples** : Fore integrated aluminum
- **Count** : front 18, rear 20
- **Lacing** : radial front and rear non-drive side, crossed 2 rear drive side

WHEEL HUB

- **Front body** : carbon with aluminum flanges
 - **Rear body** : aluminum
 - **Axle material** : aluminum
- Adjustable sealed cartridge bearings
- **Freewheel** : FTS-L steel

WHEEL WEIGHTS

Wheel weight 750