

REFERENCES WHEELS

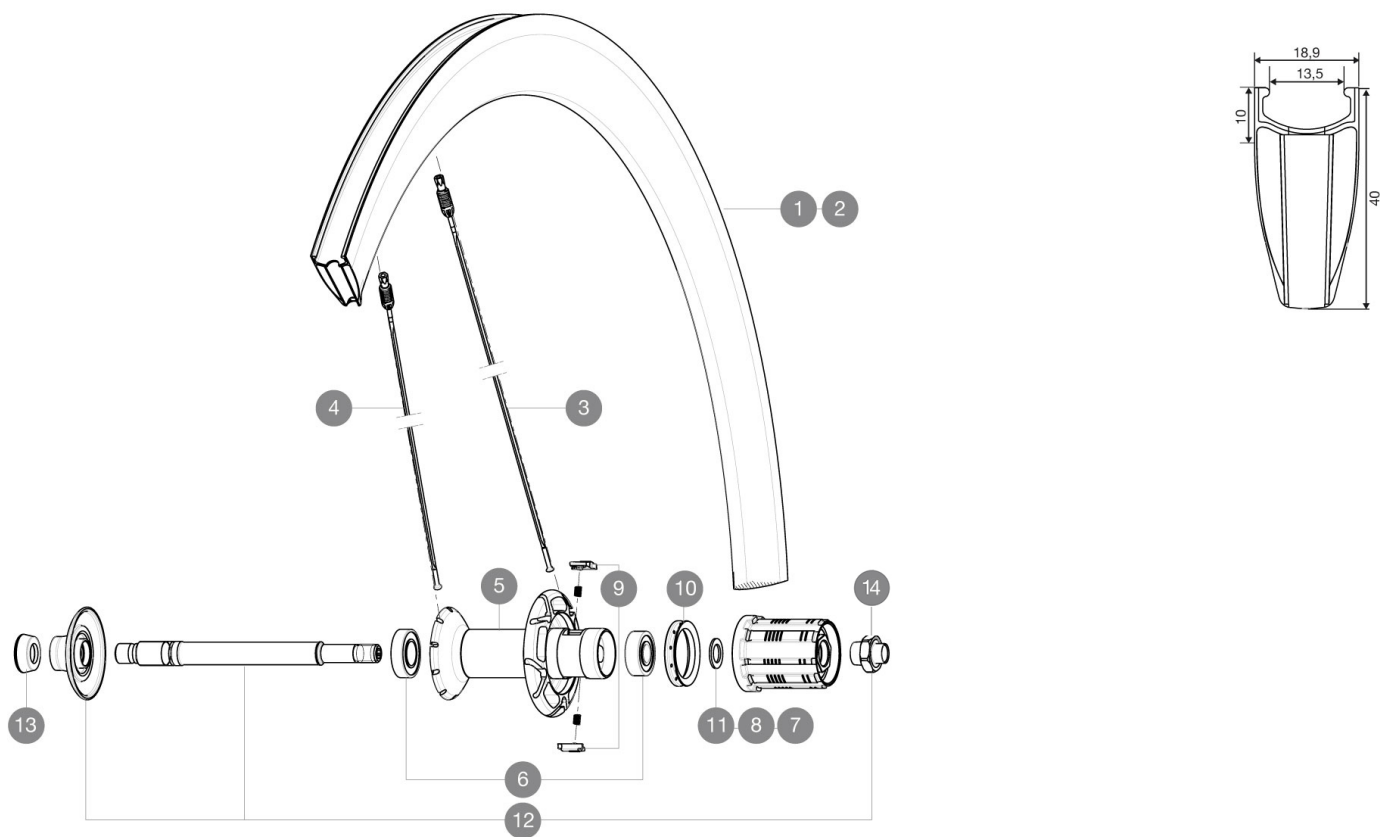

RIMS



VALVE HOLE Ø (MM): 6.5 :

| | | |
|---|-----------|--------------------------------|
| 1 | LV2400700 | KIT REAR RIM CC 40 ELITE WHITE |
| 2 | LV2400900 | KIT REAR RIM CC 40 ELITE BLACK |

SPOKES

| | | |
|---|-------------|--|
| 3 | L3297890001 | KIT 10 AERO DS CC 40 C BLACK SPOKE 275mm - while stock last |
| 3 | LV3664100 | KIT 12 DRIVE SIDE STAINLESS SPOKE CC40 C 275mm |
| 4 | LV3664200 | KIT 12 FR1/NDS STAINLESS SPOKE CC40 C 277mm |
| 4 | L3297900001 | KIT 10 AERO FT/NDS CC 40 C BLACK SPOKE 277mm - while stock l |

HUB SHELLS

| | | |
|----|-----------|--|
| 5 | N/A | HUB BODY |
| 6 | L33000000 | REAR HUB B9+6901 BEARINGS 2013 |
| 7 | L30871100 | FTS-L ROAD FREEWHEEL BODY HG11 8/9 compatible |
| 8 | L30871200 | FTS-L ROAD FREEWHEEL BODY ED11 8/9 compatible |
| 9 | LM4057800 | FTSL PAWLS KIT (ROAD WHEELS) |
| 10 | L99500000 | FTSL/FTSX FREEHUB BODY SEAL |
| 11 | L30872800 | SET OF 3 INTERNAL SILVER SPACERS 9mm FTS-L |
| 12 | LV2250300 | KIT REAR AXLE AERO HUB CXR/CC40/CC SLS/CC SLE/COSMIC PRO CAR |
| 13 | L35117300 | FT/RR FORK REST R-SYS/CC ULTIMATE > 2013/KSY PRO CARB T |
| 14 | LV2373100 | KIT NUT FOR ROAD ALLOY THROUGH AXLE 9mm |

MAVIC *Cosmic Carbone 40 Elite***DELIVERED WITH**

| | |
|---------------------------------|--|
| BR301 quick releases | |
| Carbon brake pads | |
| Multifonction adjustment wrench | |
| User guide | |

Specifications**RIMS**

- **Material** : 3K carbon fibers with aluminum reinforced rim bed
- **Height** : 40 mm
- **Drilling** : co-molded Fore drilled inserts
- **Brake track** : carbon with TgMAX technology
- **Brake track** : carbon
- **Valve hole diameter** : 6.5 mm
- **Tyre** : clincher
- **ETRTO size** : 622x13C
- **Recommended tyre sizes** : 19 to 28 mm

SPOKES

- **Material** : steel
- **Shape** : straight pull, bladed, double butted
- **Nipples** : Fore integrated aluminum
- **Count** : front 16, rear 20
- **Lacing** : radial front and rear non-drive side, crossed 2 rear drive side

WHEEL HUB

- **Front and rear bodies** : aluminum
 - **Axle material** : aluminum
- Adjustable sealed cartridge bearings
- **Freewheel** : FTS-L steel

WHEEL WEIGHTS

Wheel weight 875