

ASTM CATEGORY 1 : road only  
Recommended weight limit : 120kg

**REFERENCES WHEELS**

F33901 CosProCarbExalitFt

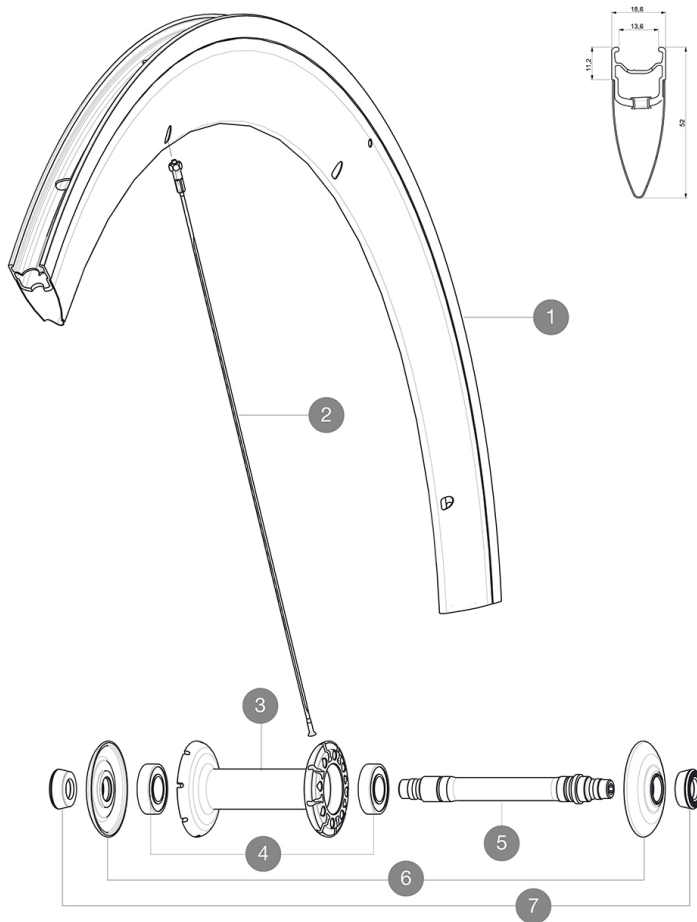

**RIMS**



VALVE HOLE Ø (MM): 6,5 :

1	LV2404500	KIT FRONT RIM COSMIC PRO CARBON EXALITH
---	-----------	---

**SPOKES**

2	L32976800	KIT 10 AERO FT/NDS CXR 60 C BLK SPOKE 289mm
2	L32979200	10 BLK FR/NDRV SPOKES CC SLE CLINCHER 2013 288mm - while sto

**HUB SHELLS**

3	N/A	HUB BODY
4	LM4007800	FRONT HUB BEARINGS 6901 x 2
5	L30870000	FRONT AXLE ROAD RIM BRAKING QRM +
6	L32985700	HUB CAP & ADJUSTING NUT CXR 80
7	L35117300	FT/RR FORK REST R-SYS/CC ULTIMATE > 2013/KSY PRO CARB T

# MAVIC Cosmic Pro Carbon Exalith

## DELIVERED WITH

BR601 quick releases	
Rim tape	
Exalith brake pads	
Multifonction adjustment wrench	
User guide	

## Specifications

### RIMS

- **Material** : Maxtal and 12K carbon fiber
- **Height** : 52 mm
- **Joint** : SUP
- **Drilling** : traditional
- **Brake track** : Exalith 2
- **Weight reduction** : ISM
- **Valve hole diameter** : 6.5 mm
- **Tyre** : clincher
- **ETRTO size** : 622x13C
- **Recommended tyre sizes** : 21 to 28 mm

### SPOKES

- **Material** : steel
- **Shape** : straight pull, bladed, double butted
- **Nipples** : front aluminum, rear brass, ABS
- **Count** : front 16, rear 20
- **Lacing** : radial front and rear non-drive side, crossed 2 rear drive side

### WHEEL HUB

- **Front and rear bodies** : aluminum
  - **Axle material** : aluminum
- Adjustable sealed cartridge bearings
- **Freewheel** : FTS-L steel

### WHEEL WEIGHTS

Wheel weight 730