

MAVIC Cosmic Pro Carbon

1
2016
FRONT

ASTM CATEGORY 1 : road only
Recommended weight limit : 120kg

REFERENCES WHEELS

| | | | |
|--------|-----------------------|--------|-----------------------|
| F34101 | CosmicProCarbFt White | F34102 | CosmicProCarbFt Black |
|--------|-----------------------|--------|-----------------------|

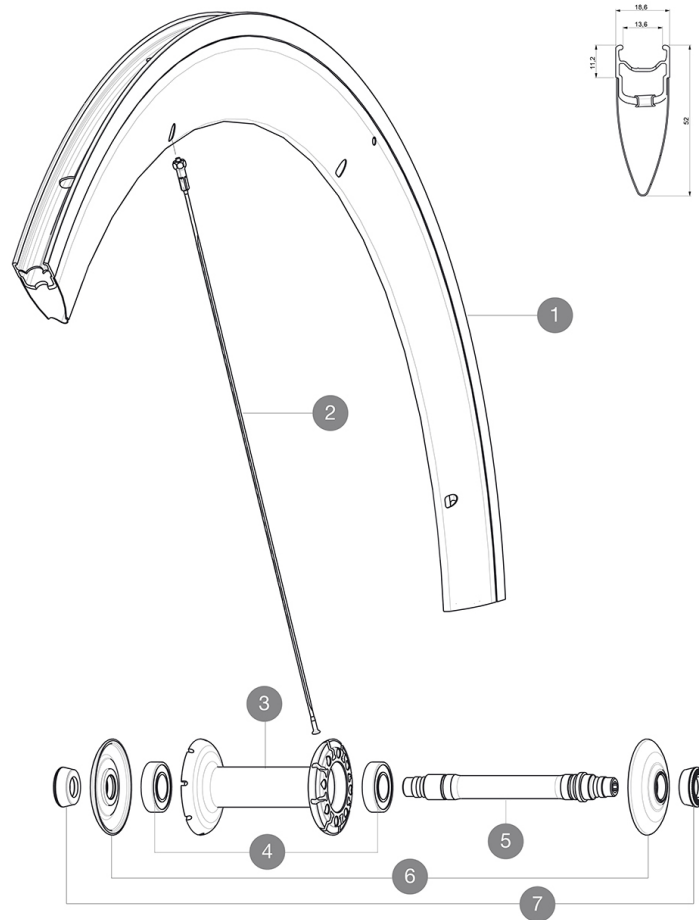

RIMS



VALVE HOLE Ø (MM): 6,5 :

| | | |
|---|-----------|---------------------------------------|
| 1 | LV2402600 | KIT BLACK FRONT RIM COSMIC PRO CARBON |
|---|-----------|---------------------------------------|

SPOKES

| | | |
|---|-----------|---|
| 2 | L36644500 | KIT 10 FT/NDS COSMIC CARBON SLS BLK SPK 289mm |
|---|-----------|---|

HUB SHELLS

| | | |
|---|-----------|---|
| 3 | N/A | HUB BODY |
| 4 | LM4007800 | FRONT HUB BEARINGS 6901 x 2 |
| 5 | L30870000 | FRONT AXLE ROAD RIM BRAKING QRM + |
| 6 | L32985700 | HUB CAP & ADJUSTING NUT CXR 80 |
| 7 | L35117300 | FT/RR FORK REST R-SYS/CC ULTIMATE > 2013/KSY PRO CARB T |

MAVIC *Cosmic Pro Carbon***DELIVERED WITH**

| | |
|---------------------------------|--|
| BR301 quick releases | |
| Rim tape | |
| Multifonction adjustment wrench | |
| User guide | |

Specifications**RIMS**

- **Material** : Maxtal and 12K carbon fiber
- **Height** : 52 mm
- **Joint** : SUP
- **Drilling** : traditional
- **Brake track** : UB Control
- **Weight reduction** : ISM
- **Valve hole diameter** : 6.5 mm
- **Tyre** : clincher
- **ETRTO size** : 622x13C
- **Recommended tyre sizes** : 21 to 28 mm

SPOKES

- **Material** : steel
- **Shape** : straight pull, bladed
- **Nipples** : brass, ABS
- **Count** : front 16, rear 20
- **Lacing** : radial front and rear non-drive side, crossed 2 rear drive side

WHEEL HUB

- **Front and rear bodies** : aluminum
 - **Axle material** : aluminum
- Adjustable sealed cartridge bearings
- **Freewheel** : FTS-L steel

WHEEL WEIGHTS

Wheel weight 765