

# MAVIC Cosmic Pro Carbon SL C Disc

ASTM CATEGORY 1 : road only  
Recommended weight limit : 120kg  
Recommended tyre sizes: 25 to 52 mm  
Max. Pressure: 25mm 7.7 bars - 110 PSI

## REFERENCES WHEELS

R71801 CosProCarbSLDiscNTRr R72201 CosProCarbSLDiscCLRr

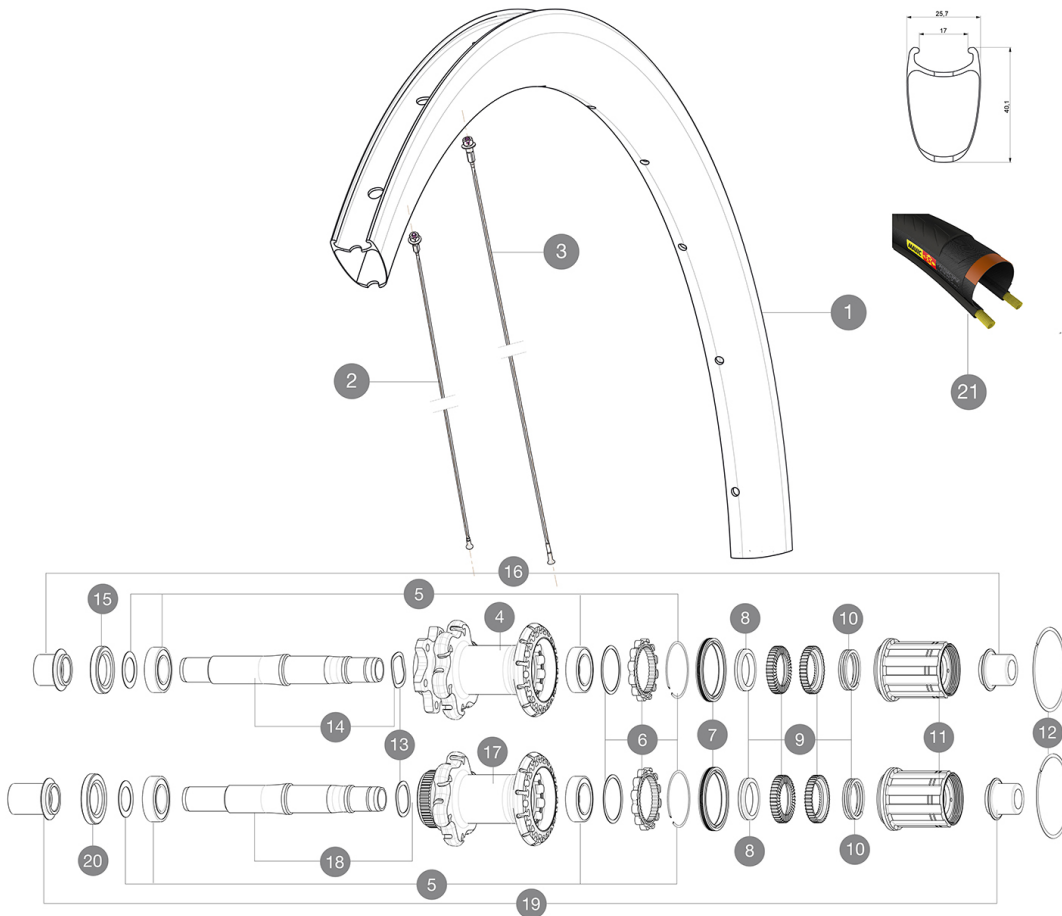

## RIMS



VALVE HOLE Ø (MM): 6,5 :

|   |           |   |
|---|-----------|---|
| 1 | LV2733300 | KIT REAR RIM COSMIC PRO CARBON SL UST DISC              |
| 1 | LV2401300 | KIT RR RIM COSMIC PRO CARBON SL Disc - while stock last |
|   | LV2690100 | KIT CARBON RIM TAPE 21x622mm - FOR CARBON RIM           |
|   | LV2620100 | UST RIM TAPE 25mm (for 21-24mm wide rim)                |

## SPOKES

|   |             |  |
|---|-------------|--|
| 2 | LV227110001 | KIT 12 DS COS PRO CARB SL/SL UST 1 UST D BTD AERO SPK 260mm/ |
| 2 | LV3662800   | KIT 12 DS COSMIC PRO CARB SL T/UST/UST Disc/C/C Disc BUTTED  |
| 3 | LV227120001 | KIT 12 NDS COS PRO CARB SL/FT SL D/FT & NDS UST & UST D SPK  |
| 3 | LV3663000   | KIT 12 FRT/NDS COSMIC PRO CARB SL UST/UST Disc C/C Disc/T Di |



## HUB SHELLS

|    |           |   |
|----|-----------|---|
| 4  | N/A       | HUB BODY                                |
| 4  | N/A       | HUB BODY                                |
| 5  | LV2560200 | KIT ID360 BEARINGS 15/28/7 + 17/28/7    |
| 6  | LV2252700 | KIT ID360 INSERT SHAPED EAR LOBE > 2017 |
| 7  | LV2251600 | KIT ID360 SEAL + GREASE                 |
| 8  | LV2500500 | KIT ID360 3 PADS NOISE REDUCING         |
| 9  | LV2251700 | KIT ID360 2 RATCHETS + SPRING + GREASE  |
| 10 | LV2251800 | KIT 3 ID360 ROAD SPRINGS                |
| 11 | LV3430100 | HG11 Freewheel Body ID360               |
| 12 | LV2252200 | KIT 2 REAR HUB RETENTION RINGS 48mm     |
| 13 | LV2251500 | KIT 3 ID360 WAVE WASHERS                |

|    |           |  |
|----|-----------|--|
| 14 | LV2251300 | KIT ID360 AXLE DISC 6 BOLTS                        |
| 15 | LV2251000 | KIT ID360 HUB THREADED CAP UB+DISC 6 BOLTS (large) |
| 16 | LB4989600 | ADAPTER Rr 12x142mm ID360 (6bolt)                  |
| 17 | N/A       | HUB BODY   |
| 17 | N/A       | HUB BODY   |
| 18 | LV2251400 | KIT ID360 AXLE DISC CENTER LOCK                    |
| 19 | LB4989900 | ADAPTER Rr 12x142mm ID360 (CLock)                  |
| 20 | LV2251100 | KIT ID360 HUB THREADED CAP DISC CENTER LOCK        |

# MAVIC Cosmic Pro Carbon SL C Disc

## DELIVERED WITH

|   |   |
|---|---|
| Rim tape  |   |
| Front 12 mm adapters  |   |
| Specific disc bolts   |   |
| Multifunction adjustment wrench   |   |
| User guide  |   |
| Front 12 mm adapters<br>(B4104201)<br>1   |  |
| Rear 12x142mm adapters for Instant Drive 360<br>(B49 896 01 for ID360 6T, B49 899 01 for ID360 CL)<br>1 |  |
| Specific disc bolts   |   |
| Rim tape  |   |
| Multifunction adjustment wrench   |   |
| User guide  |   |

## COMPATIBILITY

|   |  |
|---|--|
| Freewheel: Shimano/Sram or Campagnolo, convertible to XD-R with optional driver body                  |  |
| Front axle: convertible from 12mm thru axle to quick release or 15mm thru axle with optional adapters |  |
| Rear axle: 12mm thru axle, convertible to Quick Release with optional adapters                        |  |

## Specifications

### RIMS

- **Material** : 3K carbon fibers
- **Height** : 40 mm
- **Drilling** : traditional
- **Material** : 3K carbon fibers
- Disc brake specific profile
- **Valve hole diameter** : 6.5 mm
- **Tyre** : clincher
- **Internal width** : 17 mm
- **ETRTO size** : 622x17C
- **Recommended tyre sizes** : 25 to 52 mm
- **Height** : 40 mm
- **Drilling** : traditional
- Disc brake specific profile
- **Valve hole diameter** : 6.5 mm
- **Tyre** : clincher
- **Internal width** : 17 mm
- **ETRTO size** : 622x17C

### SPOKES

- **Material** : steel
- **Shape** : straight pull, bladed, double butted
- **Nipples** : aluminum, ABS
- **Count** : 24 front and rear
- **Lacing** : front crossed 2, rear Isopulse
- **Material** : steel
- **Shape** : straight pull, bladed, double butted
- **Nipples** : aluminum, ABS

- **Count** : 24 front and rear
- **Lacing** : front crossed 2, rear Isopulse

### WHEEL HUB

- **Front and rear bodies** : aluminum
- **Axle material** : aluminum
- Sealed cartridge bearings
- **Freewheel** : Instant Drive 360
- **Front and rear bodies** : aluminum
- **Front** : Quick release, 12 thru and 15 thru compatible
- **Axle material** : aluminum
- **Rear** : 12x142 (convertible to quick release with optional adapters)
- Sealed cartridge bearings
- **Freewheel** : Instant Drive 360
- **Front** : Quick release, 12 thru and 15 thru compatible
- **Rear** : 12x142 (convertible to quick release with optional adapters)

### VERSIONS

- **Color** : Black only
- **Disc standard** : 6 Bolts or Center Lock(R)

### WHEEL WEIGHTS

Wheel weight 820