



Cosmic Pro Carbon

参照ホイール

R99471	Cos Pro Car 17 Rr Custom	R80802	Cos Pro Car 17 Rr White
R80801	Cos Pro Car 17 Rr Black		

ASTM CATEGORY 1 : road only
 For a longer longevity of the wheel, Mavic recommends that the total weight supported by the wheels don't exceed 120kg, bike included
 Recommended tyre sizes: 25 to 32 mm
 23mm 8.7 bars - 125 psi, 25mm 7.7 bars - 110 psi
 Max. Pressure: 25mm 7.7 bars - 110 PSI

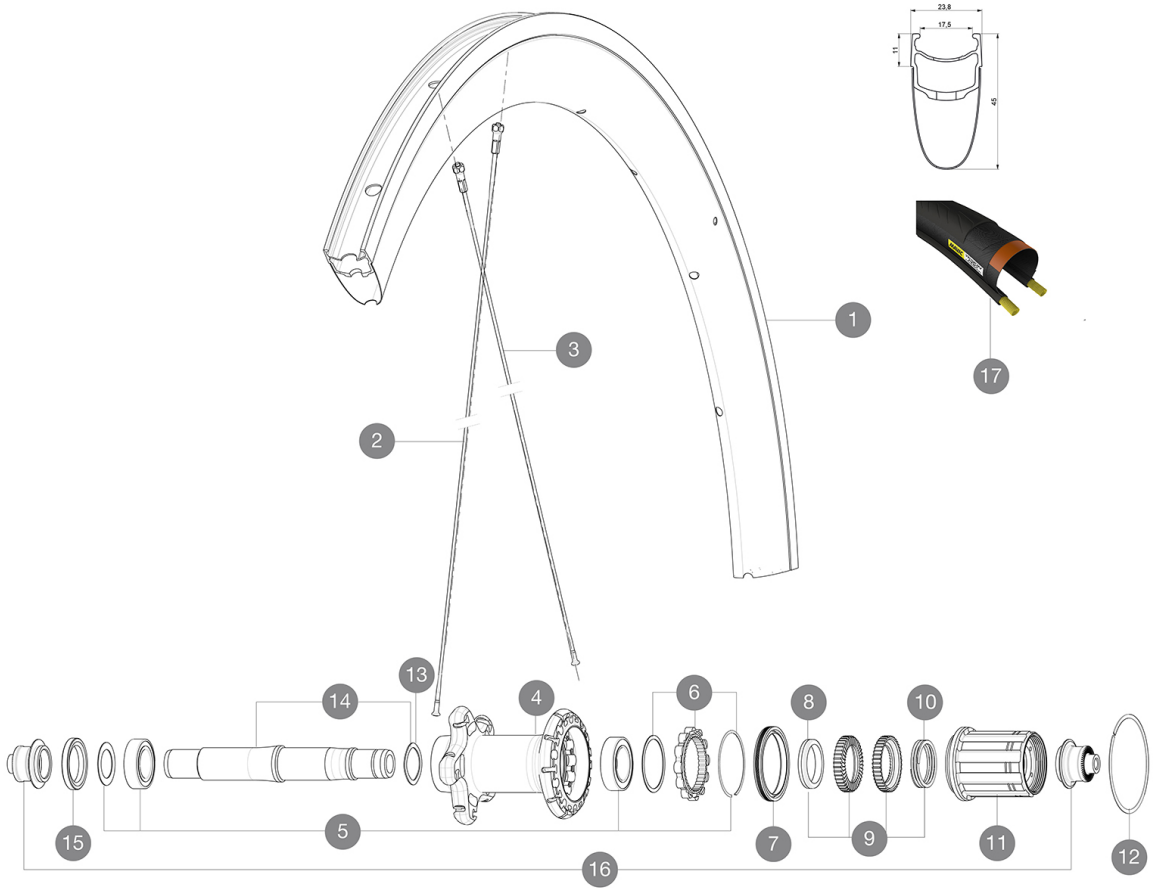

RIMS



&NBSP;:

1	LV4091900	KIT REAR RIM COSMIC PRO CARBON U shaped
1	LV2407600	KIT REAR RIM COSMIC PRO CARBON UB WHITE - while stock last
1	LV2407400	KIT REAR RIM COSMIC PRO CARBON UB GRAPHITE - while stock las

14	LV2251200	ID360 AXLE UB
15	LV2250900	KIT ID360 HUB THREADED CAP for UB model (small)
16	LB4989400	Rear axle adapters 9mm QR

TYRES

17	L37805500	Yksion Pro PowerLink White 25
----	-----------	-------------------------------

SPOKES

2	LV227470001	KIT 12 NDS BTD AERO SPK 301mm/ALU NIPPLE - while stock last
2	LV3663600	KIT 12 NON DRIVE SIDE BUTTED AERO STAINLESS SPOKE 301 +
3	LV3663500	RIT 12 BUTTED AERO STAINLESS SPOKE 277 + alu nipple + washer
3	LV227460001	KIT 12 DS BTD AERO SPK 277mm/ALU NIPPLE - while stock last

HUB SHELLS

4	N/A	HUB BODY
5	V2560401	KIT ID360 2 BEARINGS 17x28x7 + CIRCLIP + WAVED WASHER (QRM)
6	LV2252700	KIT ID360 INSERT SHAPED EAR LOBE > 2017
7	LV2251600	ID360 SEAL + GREASE
8	LV2500500	Kit 3 ID360 pad for noise reduction
9	LV2251700	ID360 2 RATCHETS + SPRING + GREASE
10	LV2251800	KIT 3 ID360 ROAD SPRINGS
11	LV3430100	HG11 Freewheel Body ID360
12	LV2252200	KIT 2 REAR HUB RETENTION RINGS 48mm
13	LV2251500	3 ID360 WAVE WASHERS



Cosmic Pro Carbon

付属品

BR301 quick releases (V24 501 01 frt, V24 502 01 rear) 1	
BR301 quick releases (V24 501 01 frt, V24 502 01 rear) 1	
BR301 quick releases (V24 501 01 frt, V24 502 01 rear) 1	
Rim tape	
Rim tape	
Rim tape	
Multifunction adjustment wrench (325 423 01) 1	
Multifunction adjustment wrench (325 423 01) 1	
Multifunction adjustment wrench (325 423 01) 1	
User guide	
User guide	
User guide	

COMPATIBILITY

Freewheel: Shimano/Sram, convertible to Campagnolo and XD-R with optional driver bodies	
Freewheel: Shimano/Sram, convertible to Campagnolo and XD-R with optional driver bodies	
Freewheel: Shimano/Sram, convertible to Campagnolo and XD-R with optional driver bodies	
Front axle: Quick Release only	
Front axle: Quick Release only	
Front axle: Quick Release only	
Rear axle: Quick Release only	
Rear axle: Quick Release only	
Rear axle: Quick Release only	

Specifications

- リム**
- Material : Maxtal and 12K carbon fiber
 - Material : Maxtal and 12K carbon fiber
 - Material : Maxtal and 12K carbon fiber
 - Height : 45 mm
 - Height : 45 mm
 - Height : 45 mm
 - Joint : SUP
 - Joint : SUP
 - Joint : SUP
 - Drilling : traditional
 - Drilling : traditional
 - Drilling : traditional
 - Brake track : UB Control
 - Brake track : UB Control
 - Brake track : UB Control
 - Weight reduction : ISM
 - Weight reduction : ISM
 - Weight reduction : ISM
 - Valve hole diameter : 6.5 mm
 - Valve hole diameter : 6.5 mm
 - Valve hole diameter : 6.5 mm
 - Tyre : clincher
 - Tyre : clincher
 - Tyre : clincher
 - Internal width : 17 mm
 - Internal width : 17 mm
 - Internal width : 17 mm
 - ETRTO size : 622x17C

- ホイールハブ**
- Front and rear bodies : aluminum
 - Front and rear bodies : aluminum
 - Front and rear bodies : aluminum
 - Axle material : aluminum
 - Axle material : aluminum
 - Axle material : aluminum
- iiQRM+iiiiii
iiQRM Auto
iiQRM+iiiiii
iiQRM Auto
Sealed cartridge bearings
- Freewheel : Instant Drive 360
 - Freewheel : Instant Drive 360
 - Freewheel : Instant Drive 360

ホイールの重み
ホイール重量 (クイックリリー
スおよびクリンチャー/チュー
ブラーを除く) (g) : 925

- VERSIONS**
- Color : Black only
 - Color : Black only