

ASTM CATEGORY 1 : road only  
Recommended weight limit : 120kg  
Recommended tire sizes: 23 to 32 mm  
Max. Pressure: 23mm 8.7 bars - 125 psi, 25mm 7.7 bars - 110 psi

## REFERENCES WHEELS

R98181 CXREliteDCLRr12x142

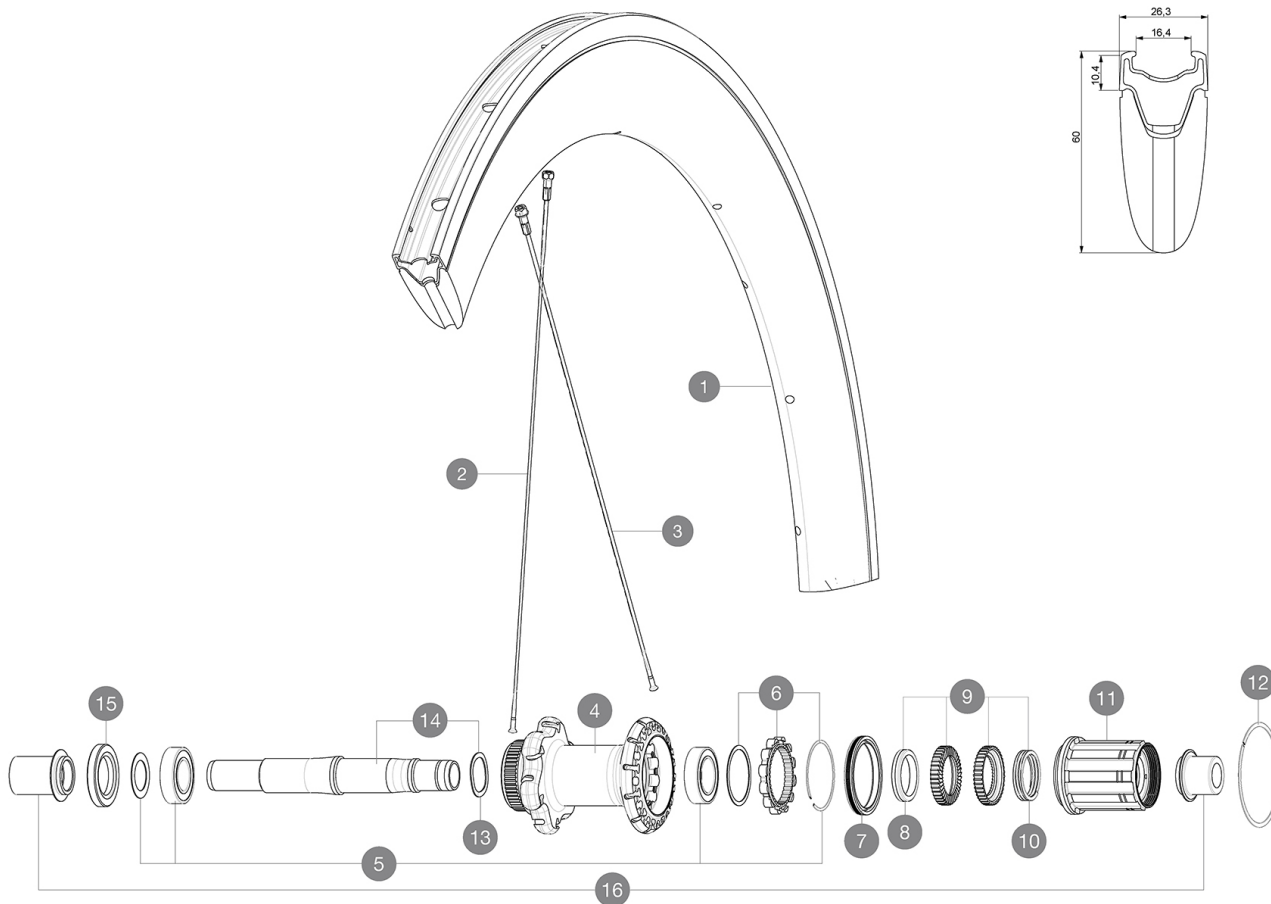

## RIMS



VALVE HOLE Ø (MM): 6.5 :

|   |           |  |
|---|-----------|--|
| 1 | LV2408800 | KIT REAR RIM CXR ELITE DISC - until stock last |
|   | LV2690200 | KIT CARBON RIM TAPE 18x622mm - FOR CARBON RIM  |

## SPOKES





|   |           |  |
|---|-----------|--|
| 2 | LV2275200 | KIT 12 NDS/FT DISC/RR D SIDE BTD SPK 290mm/W N CXR Elite |
| 3 | LV2275100 | KIT 12 DS UB/DISC BTD SPK 272mm/WIDE NIPPLE CXR Elite    |

## HUB SHELLS

|    |           |   |
|----|-----------|---|
| 4  | N/A       | HUB BODY  |
| 5  | LV2560200 | KIT ID360 BEARINGS 15/28/7 + 17/28/7            |
| 6  | LV2252700 | KIT ID360 INSERT SHAPED EAR LOBE > 2017         |
| 7  | LV2251600 | KIT ID360 SEAL + GREASE                         |
| 8  | LV2500500 | KIT ID360 3 PADS NOISE REDUCING                 |
| 9  | LV2251700 | KIT ID360 2 RATCHETS + SPRING + GREASE          |
| 10 | LV2251800 | KIT 3 ID360 ROAD SPRINGS                        |
| 11 | LV3430100 | HG11 Freewheel Body ID360                       |
| 12 | LV2252200 | KIT 2 REAR HUB RETENTION RINGS 48mm             |
| 13 | LV2251500 | KIT 3 ID360 WAVE WASHERS                        |
| 14 | LV2251400 | KIT ID360 AXLE DISC CENTER LOCK                 |
| 15 | LV2250900 | KIT ID360 HUB THREADED CAP for UB model (small) |
| 16 | LB4989900 | ADAPTER Rr 12x142mm ID360 (CLock)               |

# MAVIC CXR Elite Disc

## DELIVERED WITH

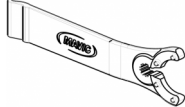
|   |   |
|---|---|
| Front 12 mm adapters<br>(B4104201)<br>1   |  |
| Rear 12x142mm adapters for Instant Drive 360<br>(B49 896 01 for ID360 6T, B49 899 01 for ID360 CL)<br>1 |  |
| Valve extender<br>(118 952 01)<br>1   |  |
| Specific disc bolts<br>(308 719 01)<br>Pack of 6  |  |
| Rim tape  |   |
| Multifunction adjustment wrench<br>(325 423 01)<br>1  |  |
| User guide  |   |

## COMPATIBILITY

|   |  |
|---|--|
| Freewheel: Shimano/Sram, convertible to Campagnolo and XD-R with optional driver bodies               |  |
| Front axle: convertible from 12mm thru axle to quick release or 15mm thru axle with optional adapters |  |
| Rear axle: 12mm thru axle, convertible to Quick Release with optional adapters                        |  |

## Specifications

### RIMS

- **Material** : Maxtal alloy with Blackcell flange
- **Height** : 60 mm
- **Drilling** : traditional
- Disc brake specific profile
- **Valve hole diameter** : 6.5 mm
- **Tire** : clincher
- **Internal width** : 16 mm
- **ETRTO size** : 622x16C

### SPOKES

- **Material** : steel
- **Shape** : straight pull, bladed, double butted
- **Nipples** : aluminum, ABS
- **Count** : 24 front and rear
- **Lacing** : front crossed 2, rear Isopulse

### WHEEL HUB

- **Front and rear bodies** : aluminum
- **Axle material** : aluminum
- Sealed cartridge bearings
- **Freewheel** : Instant Drive 360
- **Front** : Quick release, 12 thru and 15 thru compatible
- **Rear** : 12x142 (convertible to quick release with optional adapters)

### VERSIONS

- **Color** : Black only
- **Disc standard** : 6 Bolts or Center Lock(R)

### WHEEL WEIGHTS

Wheel weight 1050