

MAVIC Cosmic Pro Carbon SL T

ASTM CATEGORY 2 : road and offroad with jumps less than 15cm
 Recommended weight limit : 120kg
 Recommended tire sizes: 25 to 32 mm
 Max. Pressure: 23mm 8.7 bars - 125 psi, 25/28mm 7.7 bars - 110 psi
 Max. Pressure: 25mm 7.7 bars - 110 PSI

REFERENCES WHEELS

R98311 Cosmic Pro Car SL T Rr

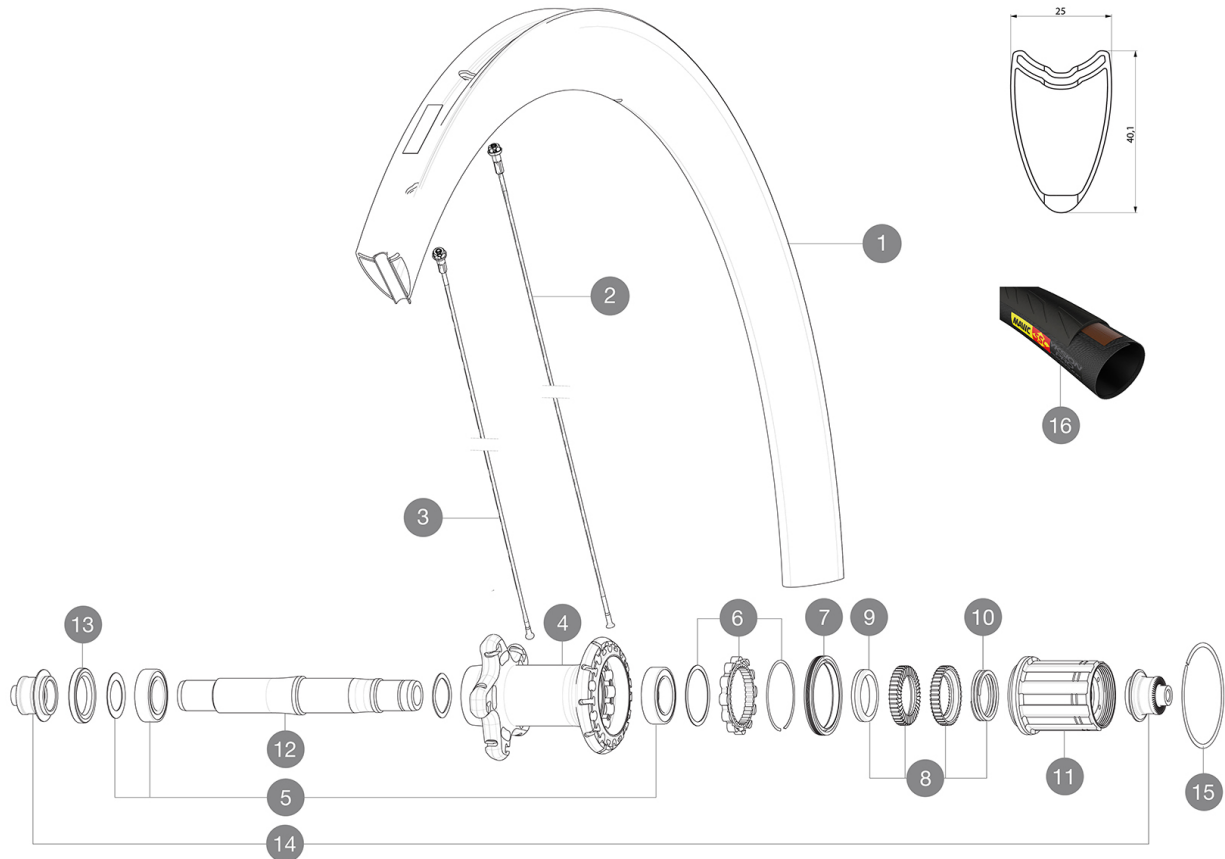

RIMS



&NBSP;:

1 LV2406600 KIT REAR RIM COSMIC PRO CARBON SL TUBULAR

TYRES

16 L37804600 Yksion ProPowerTub SSC

SPOKES







2 LV227400001 KIT 12 DS BTD AERO SPK 260mm/ALU NIPPL/WASHER - while stock
 2 LV3662800 KIT 12 DS COSMIC PRO CARB SL T/UST/UST Disc/C/C Disc BUTTED
 3 LV3663800 KIT 12 FRT KSYR PRO CARB SL C/UST/T & NDS COSMIC PRO CARB SL
 3 LV227760001 KIT 12 NDS COSMIC PRO CARBON SL T 285mm SPK - while stock la

HUB SHELLS

4 N/A HUB BODY
 5 LV2560100 KIT ID360 BEARINGS 15/26/7 + 17/28/7
 6 LV2252700 KIT ID360 INSERT SHAPED EAR LOBE > 2017
 7 LV2251600 KIT ID360 SEAL + GREASE
 8 LV2251700 KIT ID360 2 RATCHETS + SPRING + GREASE
 9 LV2500500 KIT ID360 3 PADS NOISE REDUCING
 10 LV2251800 KIT 3 ID360 ROAD SPRINGS
 11 LV3430100 HG11 Freewheel Body ID360
 12 LV2251200 KIT ID360 AXLE UB
 13 LV2250900 KIT ID360 HUB THREADED CAP for UB model (small)
 14 LB4989400 ADAPTER Rr 9mm QR ID360 (6bolt)
 15 LV2252200 KIT 2 REAR HUB RETENTION RINGS 48mm

MAVIC Cosmic Pro Carbon SL T

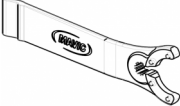
DELIVERED WITH

BR601 quick releases (V24 501 01 frt, V24 502 01 rear) 1	
BR601 quick releases (V24 501 01 frt, V24 502 01 rear) 1	
Carbon brake pads (V24 603 01 Shimano/Sram, V24 604 01 Campagnolo) 1 pair	
Carbon brake pads (V24 603 01 Shimano/Sram, V24 604 01 Campagnolo) 1 pair	
Multifunction adjustment wrench (325 423 01) 1	
Multifunction adjustment wrench (325 423 01) 1	
User guide	
User guide	

COMPATIBILITY

Freewheel: Shimano/Sram or Campagnolo, convertible to XD-R with optional driver body	
Freewheel: Shimano/Sram, convertible to Campagnolo and XD-R with optional driver bodies	
Front axle: Quick Release only	
Front axle: Quick Release only	
Rear axle: Quick Release only	
Rear axle: Quick Release only	

Specifications

RIMS

- Material : 3K carbon fibers
- Material : 3K carbon fibers
- Height : 40 mm
- Height : 40 mm
- Drilling : traditional
- Drilling : traditional
- Brake track : carbon with TgMAX technology
- Brake track : carbon with TgMAX technology
- Valve hole diameter : 6.5 mm
- Valve hole diameter : 6.5 mm
- Tyre : tubular
- ETRTO size : 28" tubular
- ETRTO size : 28" tubular

SPOKES

- Material : steel
- Material : steel
- Shape : straight pull, aero, double butted
- Shape : straight pull, bladed, double butted
- Nipples : aluminum, ABS
- Nipples : aluminum, ABS
- Count : front 16, rear 20
- Count : front 16, rear 20
- Lacing : front radial, rear Isopulse
- Lacing : front radial, rear Isopulse

WHEEL HUB

- Front and rear bodies : aluminum
- Front and rear bodies : aluminum
- Axle material : aluminum
- Axle material : aluminum
- Front bearings : adjustable sealed cartridge bearings (QRM+), Rear bearings auto adjust sealed cartridge bearings (QRM Auto)
- Sealed cartridge bearings
- Freewheel : Instant Drive 360
- Freewheel : Instant Drive 360

VERSIONS

- Color : Black only
- Color : Black only

WHEEL WEIGHTS

Wheel weight 790