

# MAVIC Ksyrium Pro Carbon SL C HR

ASTM CATEGORY 1 : road only  
Recommended weight limit : 120kg  
Recommended tire sizes: 25 to 32 mm  
Max. Pressure: 25mm 7.7 bars - 110 PSI

## REFERENCES WHEELS

R98701 KsyProCarbSLC HR Rr SV

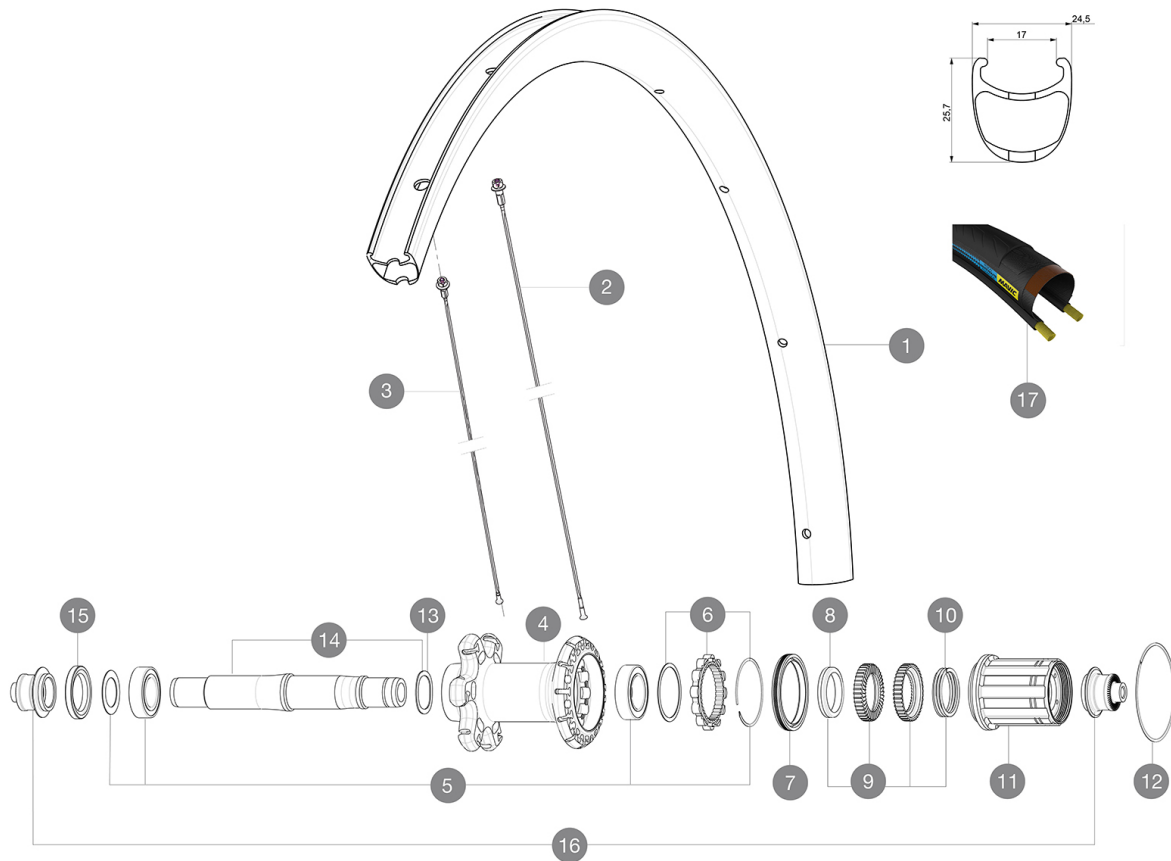

## RIMS



VALVE HOLE Ø (MM): 6,5 :

1	LV2409500	KIT RR RIM KSYRIUM PRO CARBON SL Clinch HR - while stock las
1	LV2737500	KIT REAR RIM KSYRIUM PRO CARBON SL UST
	LV2690100	KIT CARBON RIM TAPE 21x622mm - FOR CARBON RIM
	LV3720100	25mm UST Tape for 19 to 22mm Road Rims

## SPOKES

2	LV227140001	KIT 12 DS KSYRIUM PRO CARB SL T SPOKE 273mm - while stock la
2	LV3663200	KIT 12 DS KSY PRO CARB SL UST/UST Disc/C Disc/T Disc BUTTED
3	LV3663300	KIT 12 FRIT KSYR PRO CARB SL UST Disc + NDS KSYR PRO CARB SL
3	LV2273100	KIT 1 FT 285/1 FT 291/1 DS 273 KSY PRO CARB SL C/D/T HR SPK
3	LV227150001	KIT 12 FT KSY PRO CARB SL D/NDS KSY PRO CARB SL SPK 291mm -

## HUB SHELLS

4	N/A	HUB BODY
5	LV2560100	KIT ID360 BEARINGS 15/26/7 + 17/28/7
5	LV2540300	KIT REAR BEARINGS 17x28x7 + 15x26x7 CERAMIC - while stock la
6	LV2252700	KIT ID360 INSERT SHAPED EAR LOBE > 2017
7	LV2251600	KIT ID360 SEAL + GREASE
8	LV2500500	KIT ID360 3 PADS NOISE REDUCING
9	LV2251700	KIT ID360 2 RATCHETS + SPRING + GREASE
10	LV2251800	KIT 3 ID360 ROAD SPRINGS
11	LV3430100	HG11 Freewheel Body ID360
12	LV2252200	KIT 2 REAR HUB RETENTION RINGS 48mm





13	LV2251500	KIT 3 ID360 WAVE WASHERS
14	LV2251200	KIT ID360 AXLE UB
15	LV2251000	KIT ID360 HUB THREADED CAP UB+DISC 6 BOLTS (large)
16	LB4989400	ADAPTER Rr 9mm QR ID360 (6bolt)

## TYRES

17	L39436000	YksionProPowerLink HR
----	-----------	-----------------------

# MAVIC Ksyrium Pro Carbon SL C HR

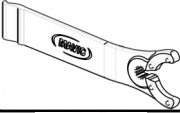
## DELIVERED WITH

BR601 quick releases (V24 501 01 frt, V24 502 01 rear) 1	
Carbon brake pads (V24 603 01 Shimano/Sram, V24 604 01 Campagnolo) 1 pair	
Rim tape	
Multifunction adjustment wrench (325 423 01) 1	
"Haute Route" special edition wheelbags 1	
User guide	

## COMPATIBILITY

Freewheel: Shimano/Sram or Campagnolo, convertible to XD-R with optional driver body	
Front axle: Quick Release only	
Rear axle: Quick Release only	

## Specifications

### RIMS

- **Material** : 3K carbon fibers
- **Height** : 25mm
- **Drilling** : traditional
- **Brake track** : carbon with TgMAX technology
- **Brake track** : carbon
- **Valve hole diameter** : 6.5 mm
- **Tire** : clincher
- **Internal width** : 17 mm
- **ETRTO size** : 622x17C

### SPOKES

- **Material** : steel
- **Shape** : straight pull, bladed, double butted
- **Nipples** : aluminum, ABS
- **Count** : front 18, rear 24
- **Lacing** : front radial, rear Isopulse

### WHEEL HUB

- **Front and rear bodies** : aluminum
  - **Axle material** : aluminum
- High quality ceramic bearings by CeramicSpeed (R)
- **Freewheel** : Instant Drive 360

### VERSIONS

- **Color** : Black only

### WHEEL WEIGHTS

Wheel weight 775