

MAVIC **Aksium Elite UST OE**

ASTM CATEGORY 1 : road only

For a longer longevity of the wheel, Mavic recommends that the total weight supported by the wheels don't exceed 120kg, bike included

Recommended tyre sizes: 25 to 32 mm

Max. Pressure tubeless: 25mm 6 bars - 87 PSI, 28mm 5 bars - 70 PSI. Max pressure tubetype: 25mm 7 bars - 102 PSI, 28mm 6 bars - 87 PSI

REFERENCES WHEELS

R23071 AksiumElite UST Pr SV

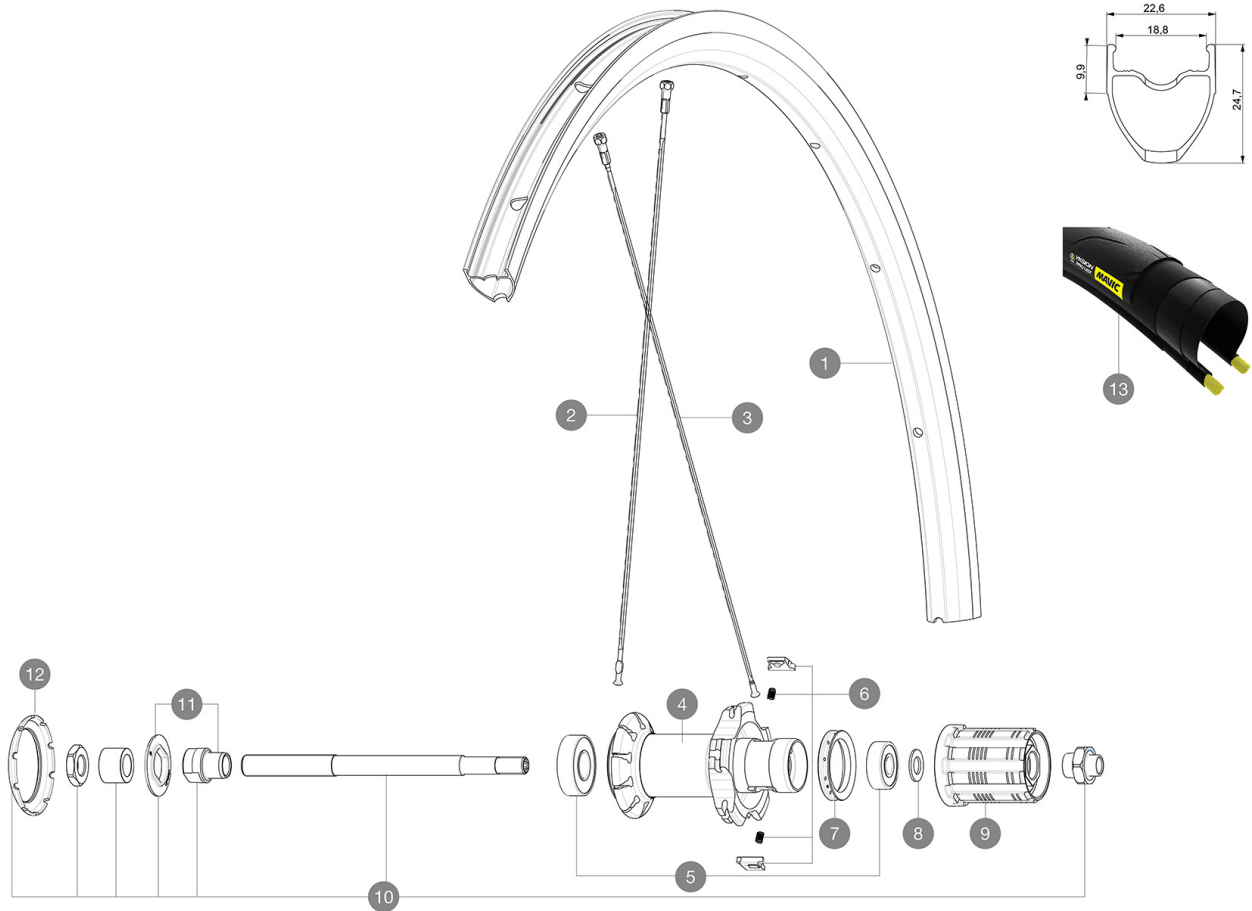
**RIMS**

&NBSP;:

| | | |
|----------|-----------|--|
| 1 | LV2735000 | KIT FRONT/REAR RIM AKSIUM ELITE UST UB SUP |
| | LV3720100 | 25mm UST Tape for 19 to 22mm Road Rims |

SPOKES

| | | |
|----------|-----------|---|
| 2 | LV3664700 | KIT 10 FRT/NDX AKSIUM ELITE UST FLAT SPOKE 282mm + nipple |
| 3 | LV3661500 | KIT 10 DS AKSIUM 19 FLAT SPOKE 301mm + nipples |

HUB SHELLS

| | | |
|-----------|-----------|---|
| 5 | LM4066000 | REAR HUB 608+6001 BEARINGS |
| 6 | LM4057800 | FTSL PAWLS KIT (ROAD WHEELS) |
| 7 | L99500000 | FTSL/FTSX FREEHUB BODY SEAL |
| 8 | L30872800 | SET OF 3 INTERNAL SILVER SPACERS 9mm FTS-L |
| 9 | L30871100 | FTS-L ROAD FREEWHEEL BODY HG11 8/9 compatible |
| 10 | L99603900 | REAR AXLE QRM ROAD 2008 |
| 11 | L99603800 | SHORT EXPENSIBLE BEARING SUPPORTS > 2008 |
| 12 | L12034400 | KIT 3 HUB CAPS AERO 10 SLOTS BLACK |

TYRES

| | | |
|-----------|----------|-----------------------|
| 13 | 39938825 | Yksion Pro UST 700x25 |
| 13 | 39938828 | Yksion Pro UST 700x28 |

MAVIC Aksium Elite UST OE

DELIVERED WITH

| | |
|---|---|
| Mavic tyre sealant (rear wheel) (355 466 01) | |
| Tyre sealant syringe | |
| BR101 quick releases (M40350 frt, M40351 rear road, M40352 rear MTB) | |
| UST valve and accessories (129 838 01) |  |
| Tubeless rim tape | |
| User guide | |

COMPATIBILITY

| | |
|--|--|
| Freewheel: Shimano/Sram, convertible to Campagnolo with optional driver body | |
| Front axle: Quick Release only | |
| Rear axle: Quick Release only | |

Specifications

RIMS

- **Material** : S6000 Aluminum
 - **Height** : 25mm
 - **Joint** : sleeved
 - **Drilling** : traditional
 - **Brake track** : UB Control
 - **Valve hole diameter** : 6.5 mm
 - **Tyre** : UST Tubeless and tubetype
 - **Internal width** : 19 mm
 - **ETRTO size** : 622x19TC Road
- Use with Mavic Tubeless Tape

SPOKES

- **Material** : steel
- **Shape** : straight pull, flat, double butted
- **Nipples** : steel, ABS
- **Count** : 20 front and rear
- **Lacing** : radial front and rear non-drive side, crossed 2 rear drive side

WHEEL HUB

- **Front and rear bodies** : aluminum
 - **Axle material** : steel
- Sealed cartridge bearings (QRM)
- **Freewheel** : FTS-L steel

WHEEL WEIGHTS

955