

MAVIC *Cosmic Pro Carbon UST*

ASTM CATEGORY 1 : road only

For a longer longevity of the wheel, Mavic recommends that the total weight supported by the wheels don't exceed 120kg, bike included

Recommended tyre sizes: 25 to 32 mm

Max. Pressure: see indication on wheel and tyre. If they differ, use the lower of the 2

Max. Pressure tubeless: 25mm 6 bars - 87 PSI, 28mm 5 bars - 70 PSI. Max pressure tubetype: 25mm 7 bars - 102 PSI, 28mm 6 bars - 87 PSI

REFERENCES WHEELS

R27891 Cosmic Pro Carbon UST Rr

R37381 Cosmic Pro Carbon UST RrNT

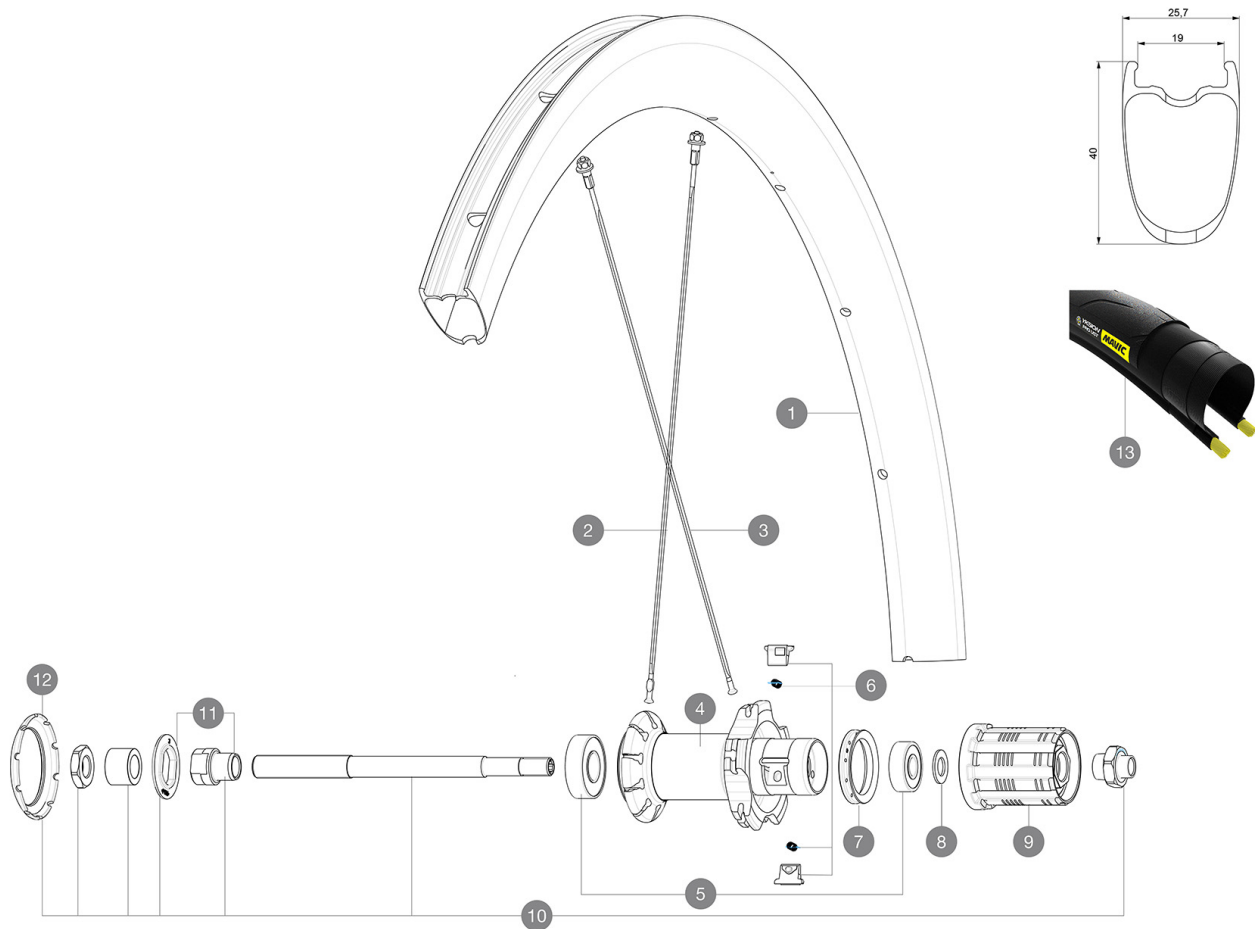
**RIMS**

&NBSP;:

| | | |
|----------|-----------|--|
| 1 | LV2734500 | KIT REAR RIM COSMIC PRO CARBON UST |
| | LV3720100 | 25mm UST Tape for 19 to 22mm Road Rims |

SPOKES

| | | |
|----------|-----------|--|
| 2 | LV4160700 | Kit 2 Front/Rear non Drive Side stamped Stainless Spokes 268 |
| 2 | LV3664400 | KIT 2 FRT/NDS COSMIC PRO CARBON UST STAMPED SPOKE 268mm - wh |
| 2 | LV4160900 | Kit 10 Front/Rear non Drive Side Stainless Spokes 268 Cosmic |
| 2 | LV3664300 | KIT 10 FRT/NDS COSMIC PRO CARBON UST SPOKE 268mm - while sto |
| 3 | LV4160100 | Kit 10 stainless spokes 285 Ft Ksyrium Equipe S/Ft & NDS Aks |

HUB SHELLS



| | | |
|-----------|-----------|---|
| 5 | LM4066000 | REAR HUB 608+6001 BEARINGS |
| 6 | LM4057800 | FTSL PAWLS KIT (ROAD WHEELS) |
| 7 | L99500000 | FTSL/FTSX FREEHUB BODY SEAL |
| 8 | L30872800 | SET OF 3 INTERNAL SILVER SPACERS 9mm FTS-L |
| 9 | L30871100 | FTS-L ROAD FREEWHEEL BODY HG11 8/9 compatible |
| 10 | L99603900 | REAR AXLE QRM ROAD 2008 |
| 11 | L99603800 | SHORT EXPENSIBLE BEARING SUPPORTS > 2008 |
| 12 | L12034400 | KIT 3 HUB CAPS AERO 10 SLOTS BLACK |

TYRES

| | | |
|-----------|----------|-----------------------|
| 13 | 39938825 | Yksion Pro UST 700x25 |
|-----------|----------|-----------------------|

MAVIC Cosmic Pro Carbon UST

DELIVERED WITH

| | |
|---|---|
| Mavic tyre sealant (rear wheel) (355 466 01) | |
| Mavic tyre sealant (rear wheel) (355 466 01) | |
| BR301 quick releases (V24 501 01 frt, V24 502 01 rear) | |
| BR301 quick releases (V24 501 01 frt, V24 502 01 rear) | |
| Tyre sealant syringe | |
| Tyre sealant syringe | |
| Carbon brake pads (V24 603 01 Shimano/Sram, V24 604 01 Campagnolo) | |
| Carbon brake pads (V24 603 01 Shimano/Sram, V24 604 01 Campagnolo) | |
| UST valve and accessories (129 838 01) |  |
| UST valve and accessories (129 838 01) |  |
| Tubeless rim tape | |
| Tubeless rim tape | |
| User guide | |
| User guide | |

COMPATIBILITY

| | |
|--|--|
| Freewheel: Shimano/Sram, convertible to Campagnolo with optional driver body | |
| Freewheel: Shimano/Sram, convertible to Campagnolo with optional driver body | |
| Front axle: Quick Release only | |
| Front axle: Quick Release only | |
| Rear axle: Quick Release only | |
| Rear axle: Quick Release only | |

Specifications

RIMS

- **Material** : 3K carbon fibers
- **Material** : 3K carbon fibers
- **Height** : 40 mm
- **Height** : 40 mm
- **Drilling** : traditional
- **Drilling** : traditional
- **Brake track** : carbon with iTgMAX technology
- **Brake track** : carbon with iTgMAX technology
- **Valve hole diameter** : 6.5 mm
- **Valve hole diameter** : 6.5 mm
- **Tyre** : UST Tubeless and tubetype
- **Tyre** : UST Tubeless and tubetype
- **Internal width** : 19 mm
- **Internal width** : 19 mm
- **ETRTO size** : 622x19TC Road

WHEEL HUB

- **Front and rear bodies** : aluminum
- **Front and rear bodies** : aluminum
- **Axle material** : steel
- **Axle material** : steel
- Sealed cartridge bearings (QRM)
- Sealed cartridge bearings (QRM)
- **Freewheel** : FTS-L steel
- **Freewheel** : FTS-L steel

VERSIONS

- **Color** : Black only

WHEEL WEIGHTS

905