

ASTM 1: 120
25 32mm
2

参照ホイール

R35121 ComProCarbSL UST TDF2 Rr

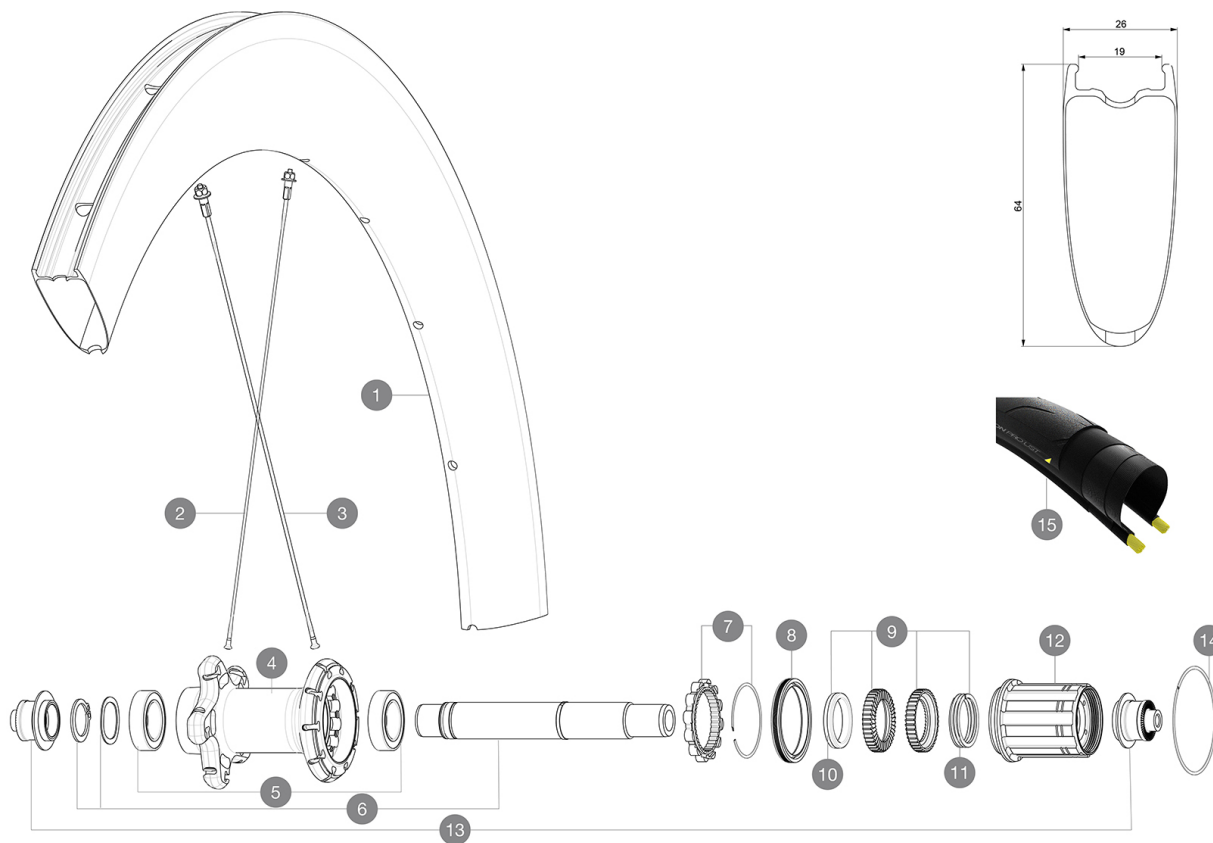

RIMS



&NBSP;:

1	LV4091200	KIT REAR RIM COMETE PRO CARBON SL UST Tdf20
	LV3720100	25mm UST Tape for 19 to 22mm Road Rims

SPOKES

2	LV3663900	KIT 12 NON DRIVE SIDE BUTTED AERO STAINLESS SPOKE 261 +
3	LV3662400	RHT 12 DS BUTTED AERO STAINLESS SPOKE 236 + alu nipp. + wash.

HUB SHELLS

4	N/A	HUB BODY
5	LV2560400	KIT ID360 2 BEARINGS 17x28x7 + CIRCLIP + WAVED WASHER (QRM)
6	LV2252800	KIT ID360 UB REAR WHEEL AXLE WITH CIRCLIP/WAVE WASHER
7	LV2252700	KIT ID360 INSERT SHAPED EAR LOBE > 2017
8	LV2251600	ID360 SEAL + GREASE
9	LV2251700	ID360 2 RATCHETS + SPRING + GREASE
10	LV2500500	Kit 3 ID360 pad for noise reduction
11	LV2251800	KIT 3 ID360 ROAD SPRINGS
12	LV3430100	HG11 Freewheel Body ID360
13	LV2253100	KIT REAR AXLE ADAPTOR QUICK RELEASE ID360
14	LV2252200	KIT 2 REAR HUB RETENTION RINGS 48mm



Comete Pro Carbon SL TDF

付属品

MAVIC <i>iiiiiiii (iiiiii)</i> (L35546600)	
BR601 <i>iii iiiiiiiii</i> (<i>iiiiii 323 485 01iiiiii 323 486 01i</i>)	
<i>iiiiiiiiii iiiii</i>	
<i>iiiiiiiiiiiii</i> (V24 603 01 <i>iiii/iiiiii V24 604 01</i> <i>iiiiiiiiii</i>)	
UST <i>iiiiiiiiiiiii</i> (L12983800)	
<i>iiiiiiiiiiiii</i>	
<i>iiiiiiiiii</i> (L32542300)	
<i>iiiiiiiiii</i>	

COMPATIBILITY

<i>iiiiiiiiiiiii/iiiiiiiiiiiii</i> <i>iiiiiiiiiiiiiXD-Riiiiiiiiii</i>	
<i>iiiiiiiiiiiii</i>	
<i>iiiiiiiiiiiii</i>	

Specifications

リム

• *iii* : 3K *iiiiiiiiii*
iiiiii64mm
iiiiiiiiiiiii
iiiiiiiiiiiii + iTgMAXiiiiii
iiiiii6.5mm
iiiiiiUST iiiiiiiiiiii
iiii19mm
 ETRTO *iiiiii622x19TC iiiii*
iiiiii iiiiiiiiiiii

スポーク

iiiiiiiiii
iiiiiiiiiiiii
iiiiiiiiiiiiiABS
iiiiiiiiii 18iiiiii 20i
iiiiiiiiiiiii iiiiiiiiiiii

ホイールハブ

iiiiiiiiii iiiiiiiiiiii
iiiiiiiiiiiii
iiiiiiiiiiiiiQRM+
iiiiiiiiiiiiiQRM
iiiiii
iiiiiiiiiiiii360

VERSIONS

iiiiiiiiiiiii

ホイールの重み

895