

MAVIC Ksyrium Pro Carbon Disc TDF

ASTM CATEGORY 1 : road only

For a longer longevity of the wheel, Mavic recommends that the total weight supported by the wheels don't exceed 120kg, bike included

Recommended tyre sizes: 25 to 32 mm

Max. Pressure: see indication on wheel and tyre. If they differ, use the lower of the 2

REFERENCES WHEELS

R35511 KsyProCarb UST DCL TDF2 Rr

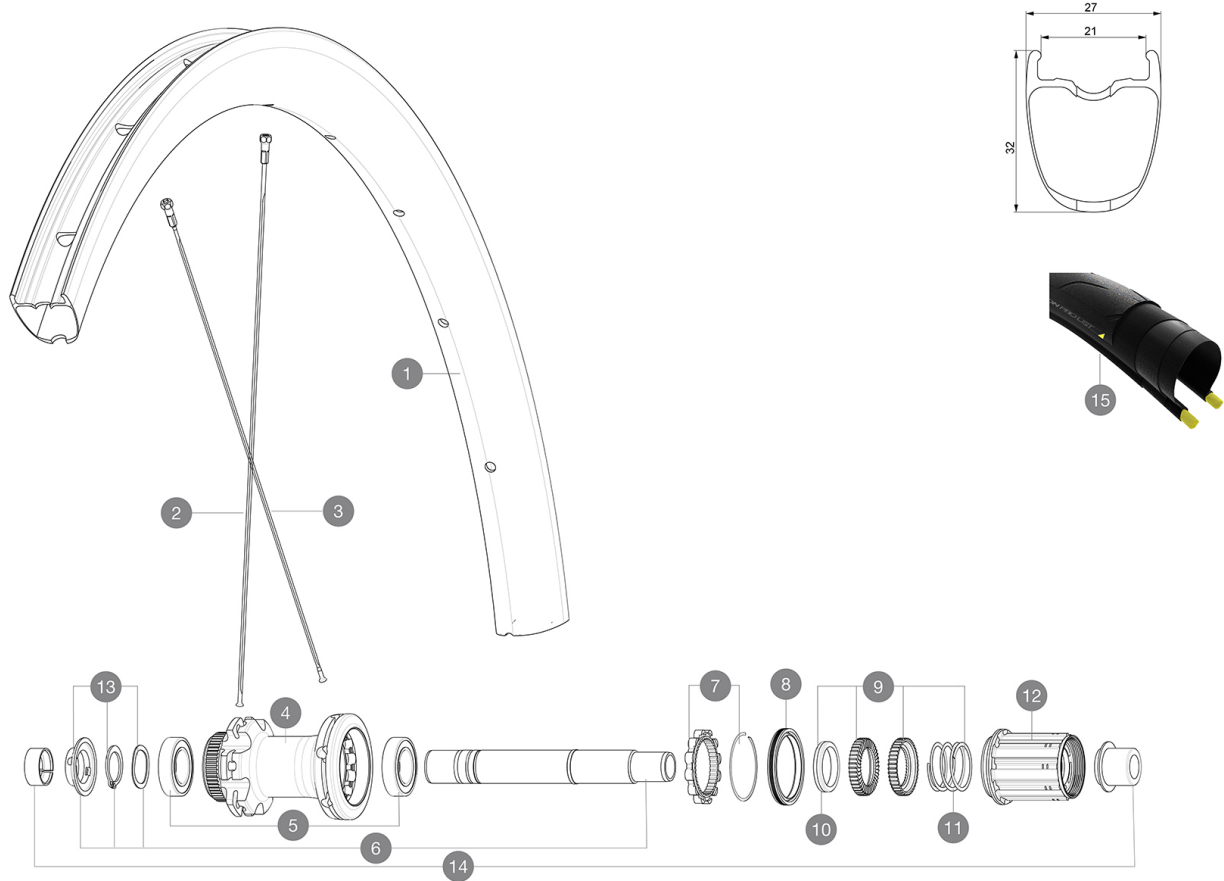

RIMS



&NBSP;:

| | | |
|---|-----------|---|
| 1 | LV4090500 | KIT REAR RIM KSYRIUM PRO CARBON UST DISC Tdf 20 |
| | LV2620100 | UST RIM TAPE 25mm (for 21-24mm wide rim) |

SPOKES

| | | |
|---|-----------|--|
| 2 | LV3665600 | KIT 12 FRt/NDs KSYRIUM PRO CARBON UST Disc SPOKE 286mm + was |
| 2 | LV4160400 | Kit 12 Front/Rear non Drive Side Stainless Spokes 286 Ksyriu |
| 3 | LV4160600 | Kit 12 Rear Drive Side Stainless Spokes 283 Ksyrium Pro Carb |
| 3 | LV3665800 | KIT 12 DS KSYRIUM PRO CARBON UST Disc SPOKE 283mm + nipple+w |

HUB SHELLS

| | | |
|----|-----------|---|
| 4 | N/A | HUB BODY |
| 5 | LM4007600 | HUB BEARINGS 17x30x7 6903 x 2 |
| 6 | LV2373400 | KIT ID360 135/142 DCL L1 AXLE WITH CLIP |
| 7 | LV2252700 | KIT ID360 INSERT SHAPED EAR LOBE > 2017 |
| 8 | LV2251600 | KIT ID360 SEAL + GREASE |
| 9 | LV2251700 | KIT ID360 2 RATCHETS + SPRING + GREASE |
| 10 | LV2500500 | KIT ID360 3 PADS NOISE REDUCING |
| 11 | LV2251800 | KIT 3 ID360 ROAD SPRINGS |
| 12 | LV3430100 | HG11 Freewheel Body ID360 |
| 13 | LV2373000 | KIT ADJUST. SYSTEM QRM AUTO ID360 for 17x30x7 bearing |
| 14 | LV2510700 | ID360V2RrAxleAdapt12x142/148 |

MAVIC Ksyrium Pro Carbon Disc TDF

DELIVERED WITH

| | |
|--|---|
| Mavic tyre sealant (rear wheel) (355 466 01) | |
| Tyre sealant syringe | |
| Front QR adapters (996 941 01 for MTB or B41 043 01 for road) | |
| Rear QR adapters for Instant Drive 360 (B49 894 01) | |
| UST valve and accessories (129 838 01) |  |
| Tubeless rim tape | |
| User guide | |

COMPATIBILITY

| | |
|---|--|
| Freewheel: Shimano/Sram, convertible to Campagnolo and XD-R with optional driver bodies | |
| Front axle: 12x100 thru axle, easily convertible to quick release with included adapters. Not compatible with 15mm through axles. | |
| Rear axle: 12mm thru axle, convertible to Quick Release with included adapters | |

Specifications

RIMS

- **Material** : 3K carbon fibers
 - **Height** : 32mm
 - **Drilling** : traditional
- Disc brake specific profile
- **Valve hole diameter** : 6.5 mm
 - **Tyre** : UST Tubeless and tubetype
 - **Internal width** : 21 mm
 - **ETRTO size** : 622x21TC ROAD
- Use with Mavic Tubeless Tape

SPOKES

- **Material** : steel
- **Shape** : straight pull, flat, double butted
- **Nipples** : steel, ABS
- **Count** : 24 front and rear
- **Lacing** : front and rear crossed 2

WHEEL HUB

- **Front and rear bodies** : aluminum
 - **Axle material** : aluminum
- Auto adjust sealed cartridge bearings (QR Auto), front and rear
- **Freewheel** : Instant Drive 360
 - **Front** : Quick release and 12x100 through axle compatible
 - **Rear** : Quick Release, 12x142 and 12x135 compatible

VERSIONS

- **Color** : Black only
- **Disc standard** : Center Lock(R) only

WHEEL WEIGHTS

870